

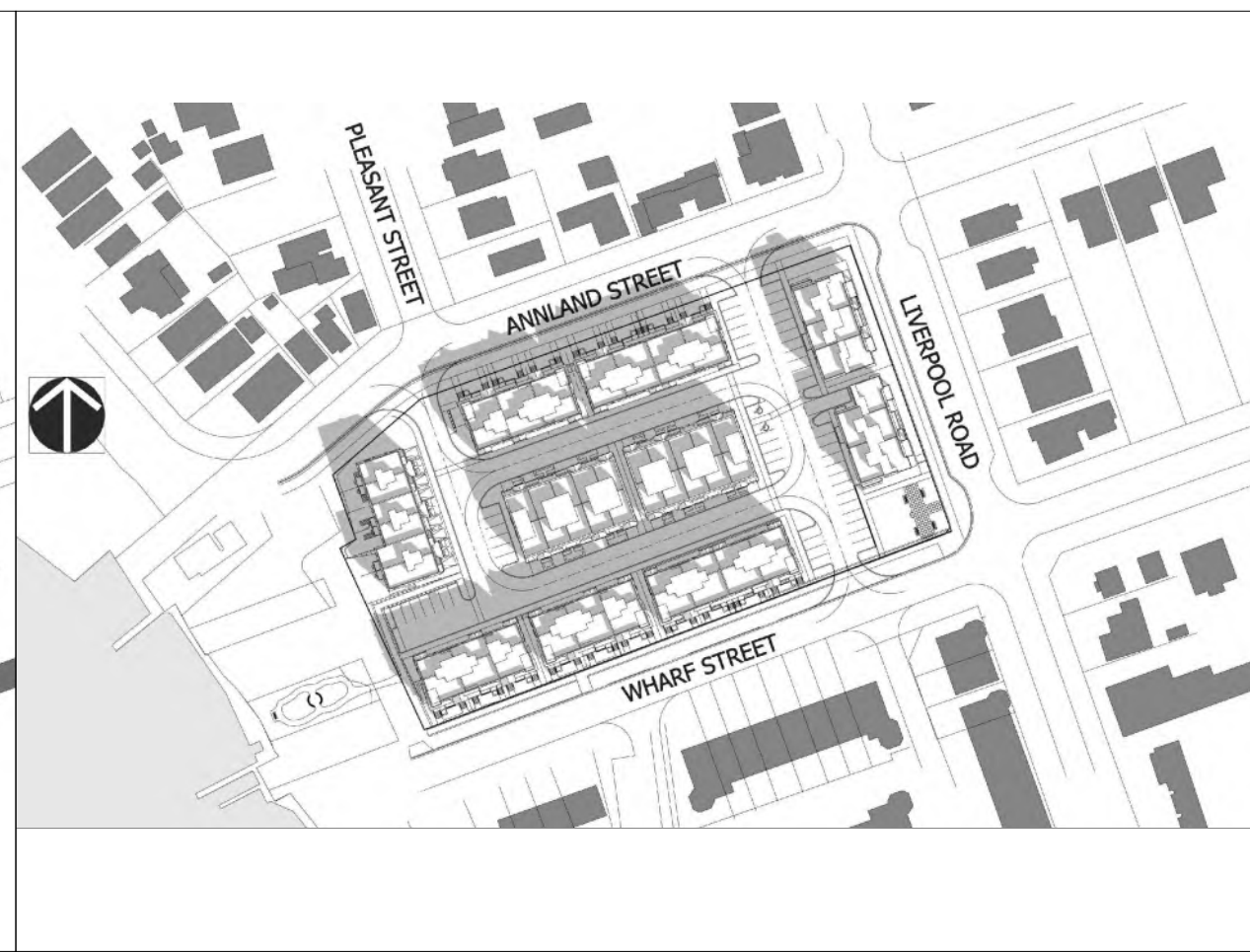

21 MARCH 9:00AM

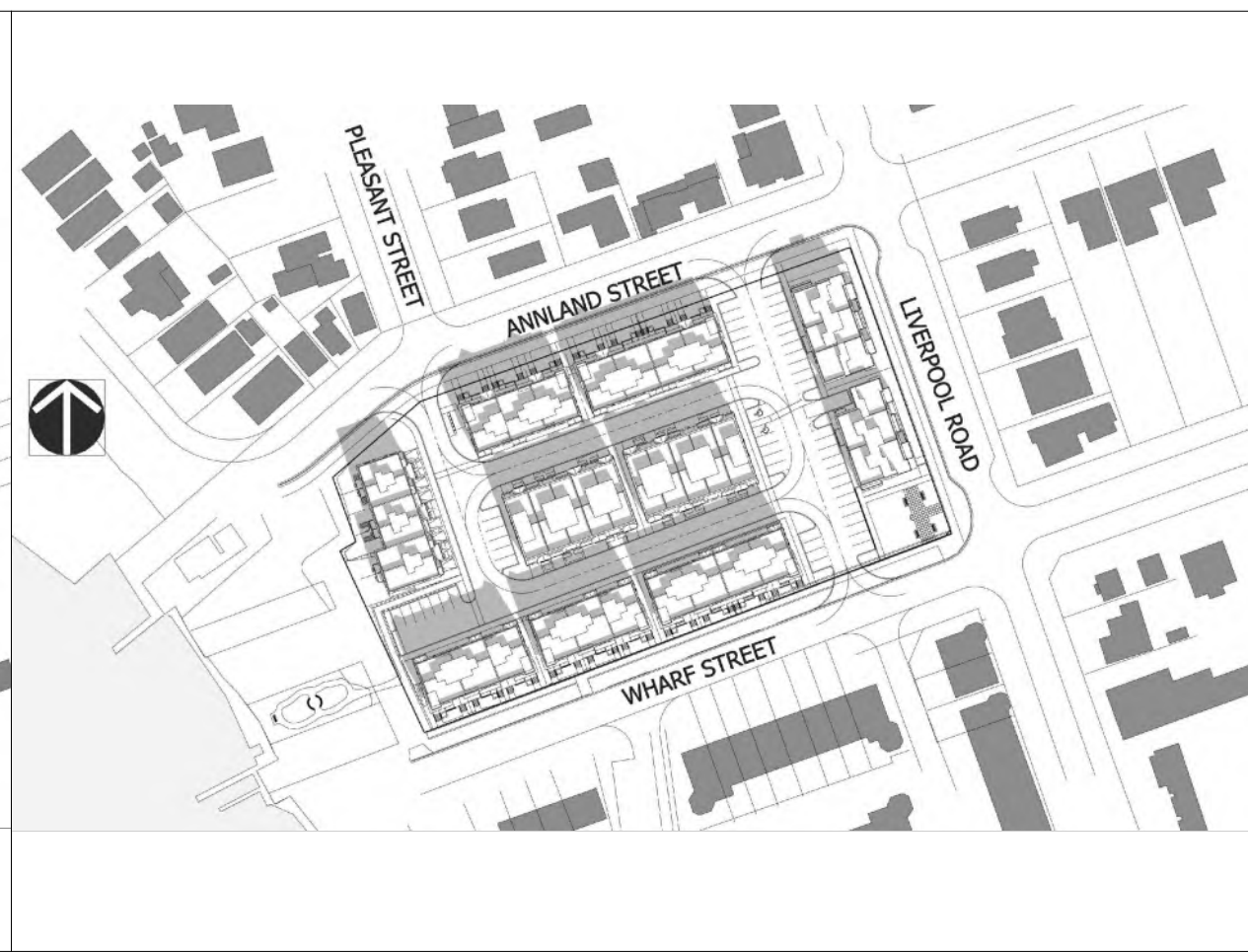

21 MARCH 10:00AM



21 MARCH 11:00AM

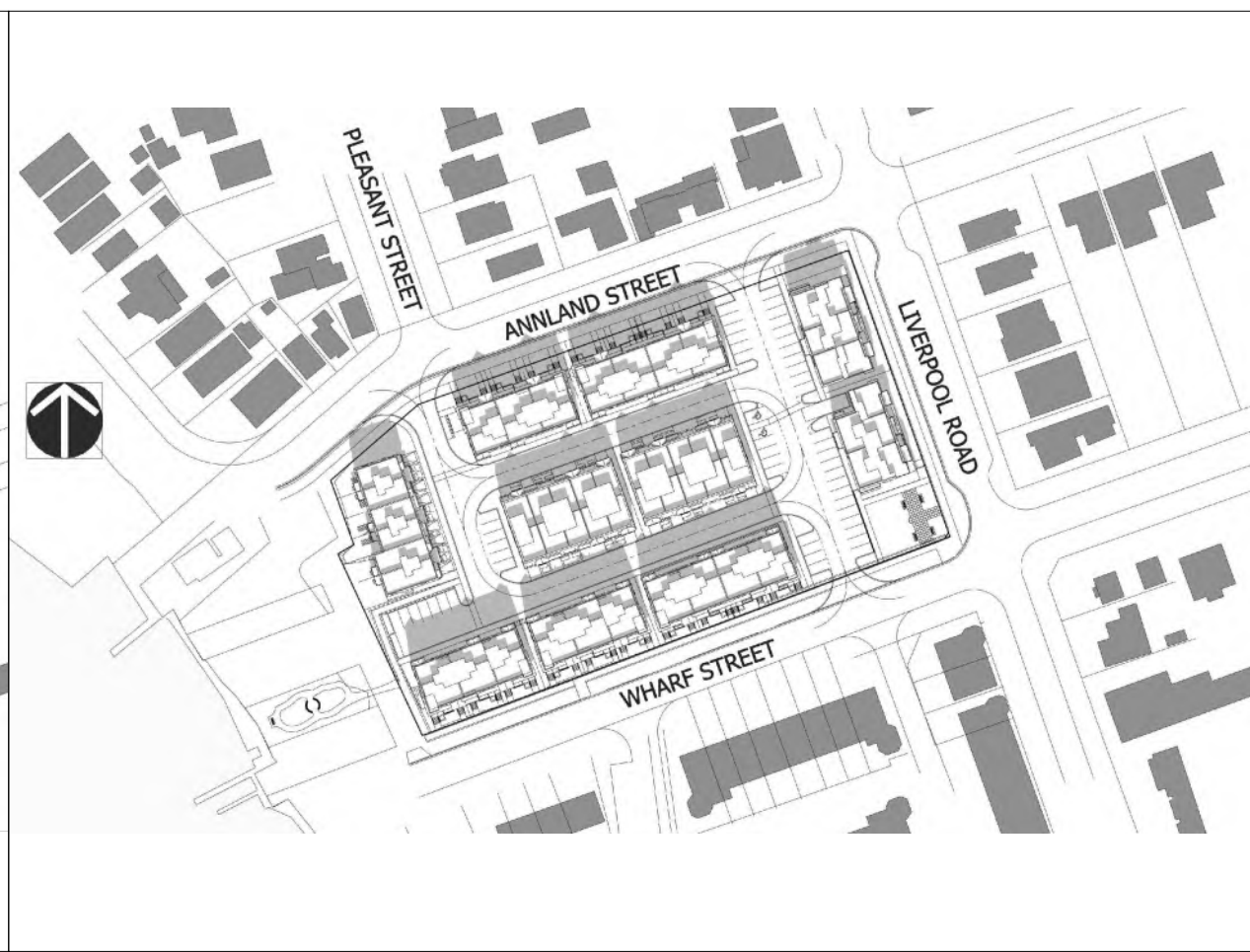

21 MARCH 12:00PM



21 MARCH 1:00PM

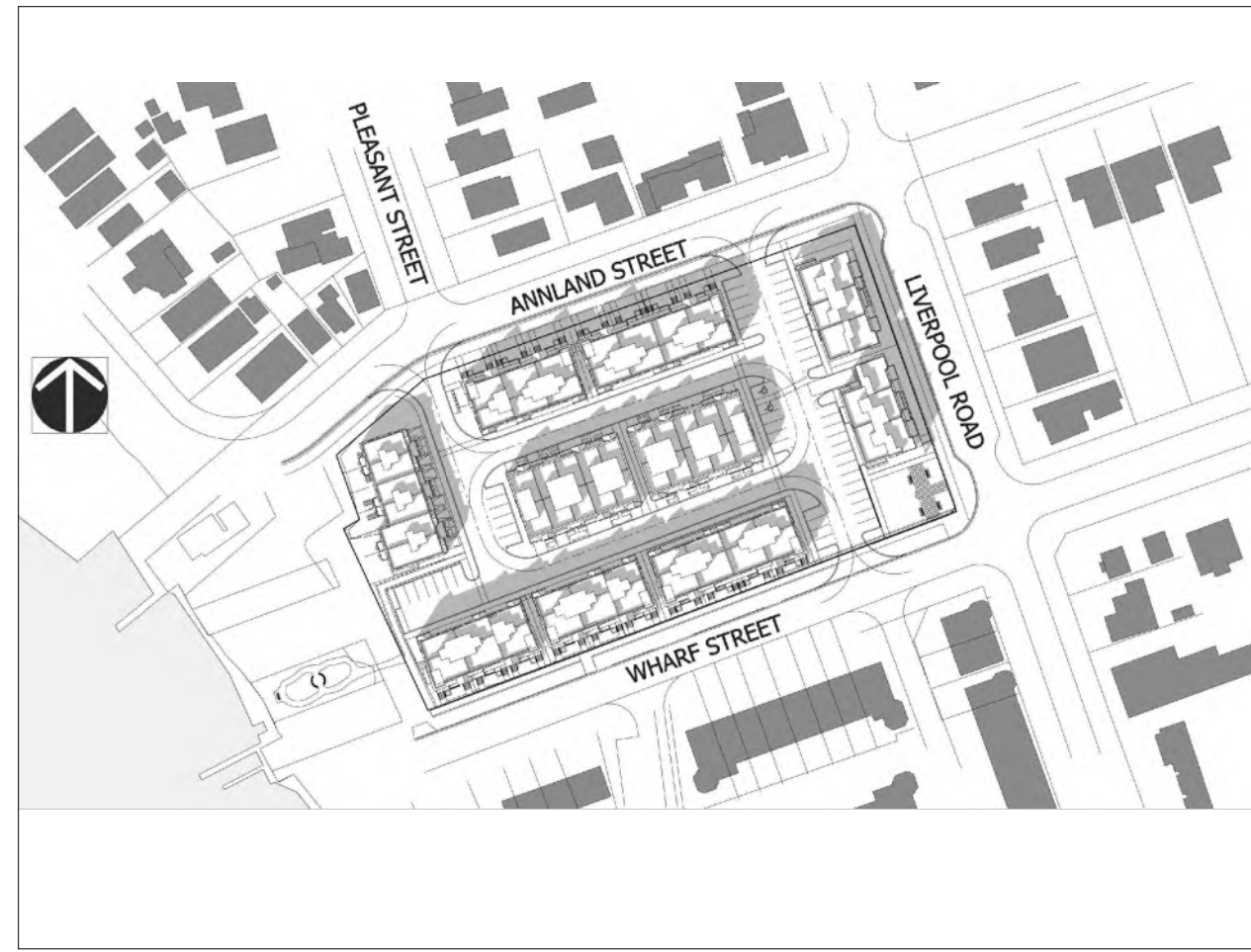

21 MARCH 2:00PM

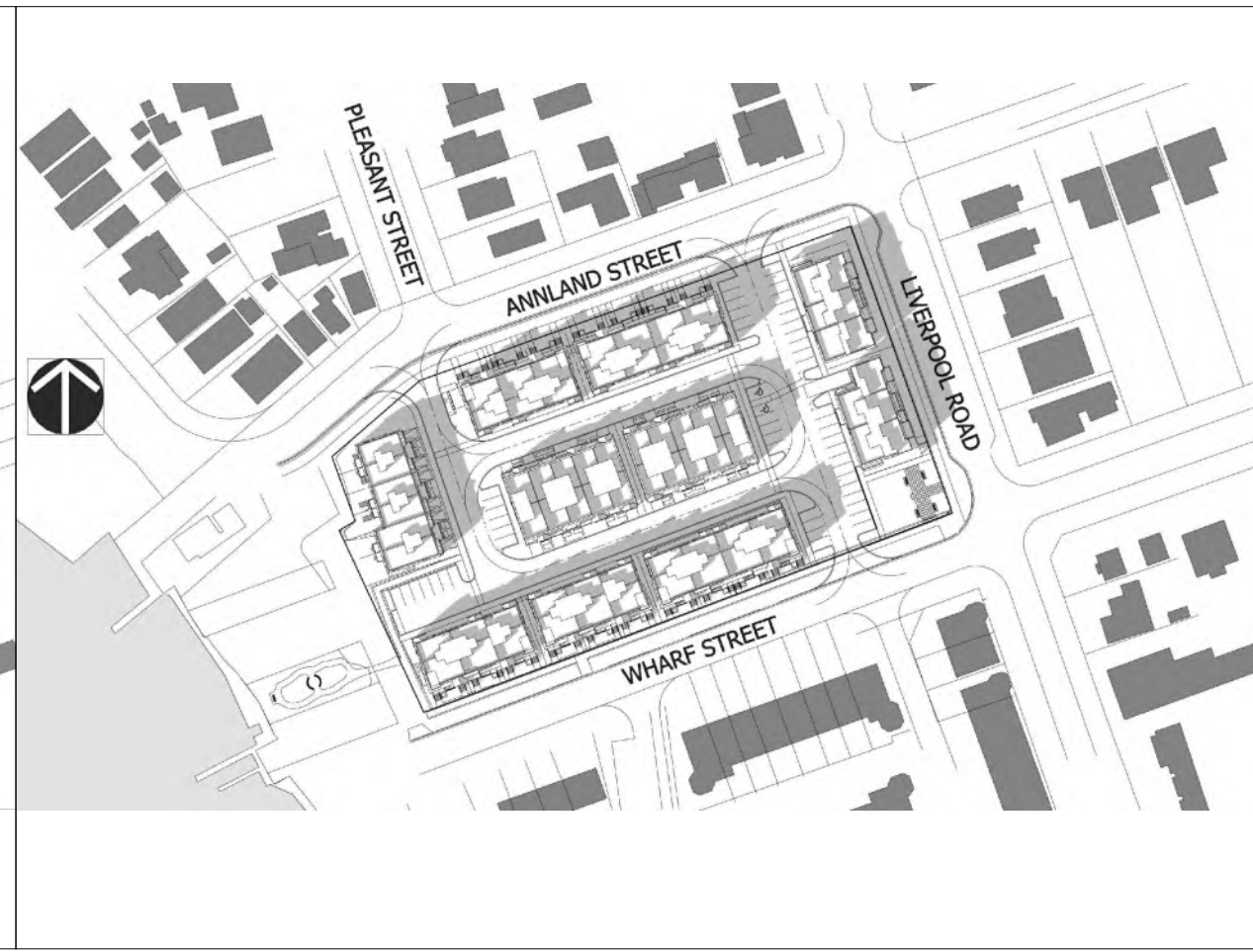

21 MARCH 3:00PM

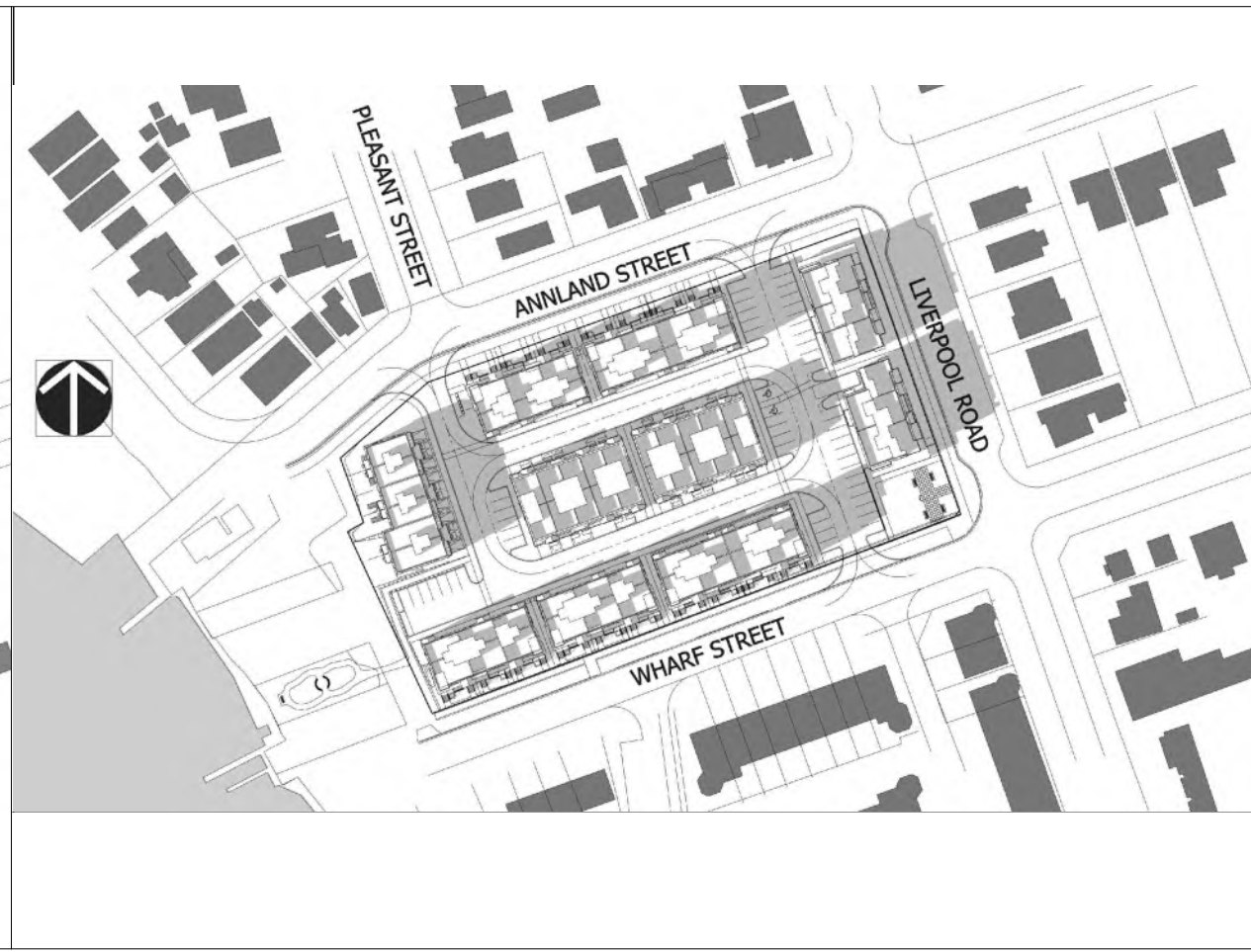

21 MARCH 4:00PM

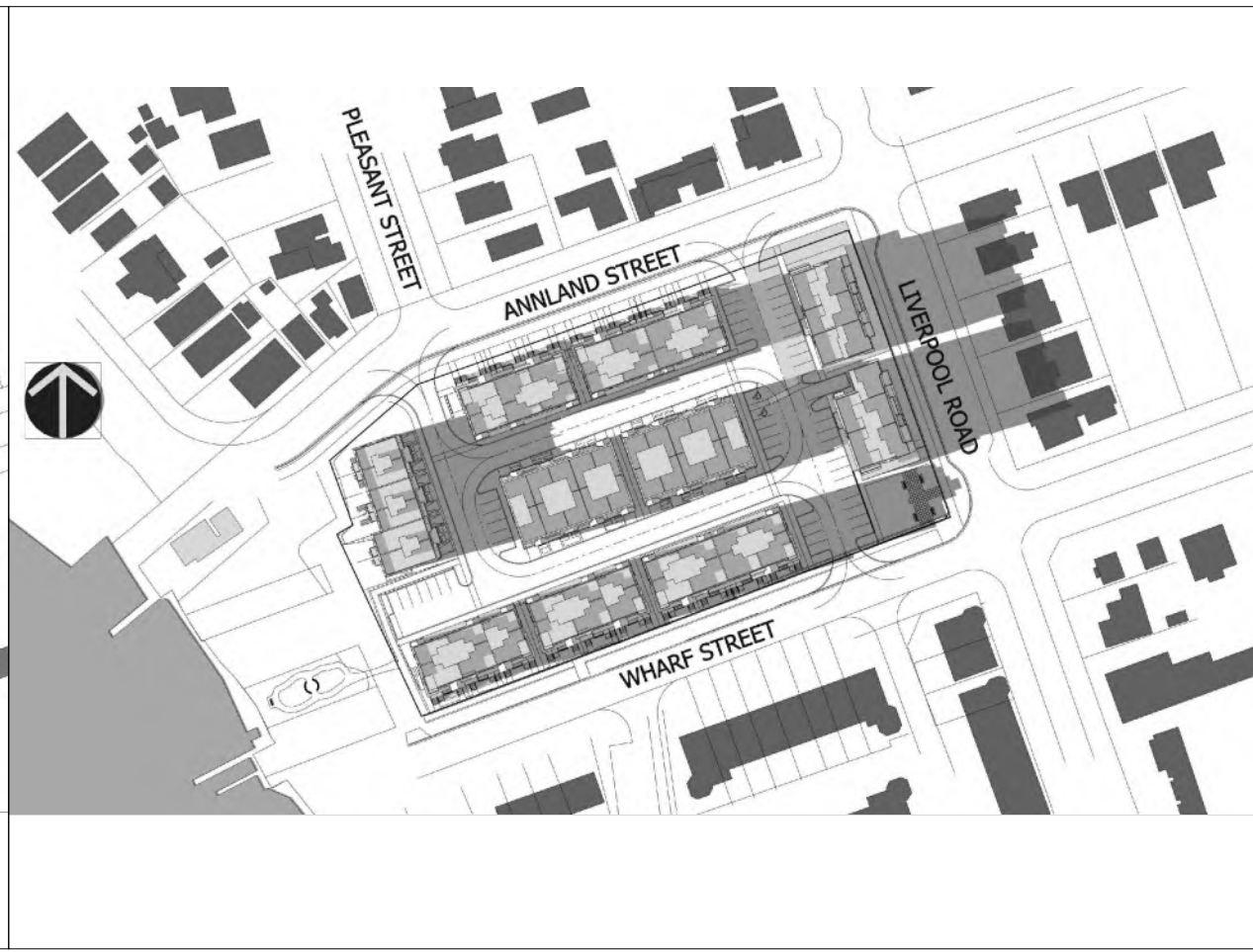

21 MARCH 5:00PM

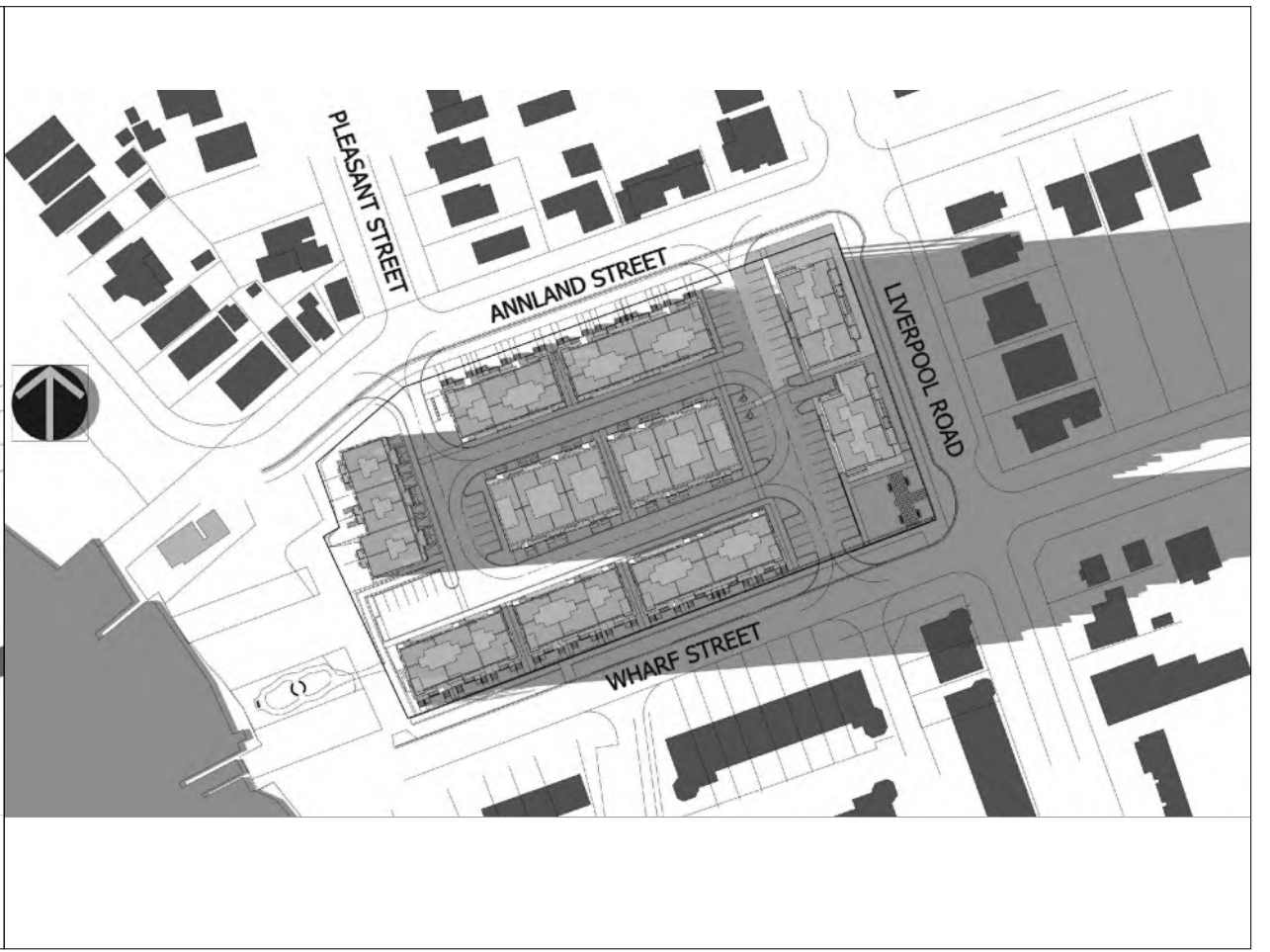

21 MARCH 6:00PM

**PROPOSED BUILDING. 3-STOREY TOWNHOMES**

THIS SHADOW ANALYSIS HAS BEEN PREPARED IN ACCORDANCE WITH THE CITY OF PICKERING TERMS OF REFERENCE FOR SHADOW/SHADING STUDY. THE ANALYSIS DEMONSTRATES THE SHADOW IMPACT BY THE PROPOSED DEVELOPMENT THROUGHOUT THE YEAR ON THE LANDS ADJACENT TO THE SUBJECT PROPERTY BY THE PROPOSED 3 STOREY TOWNHOMES BUILDING.

THE SHADOW CAST BY THE PROPOSED BUILDING HAS BEEN DEVELOPED USING A 3D SKETCHUP MODEL WHICH HAS BEEN GEOLOCATED. ONTARIO UTC-5

3	ISSUED FOR CLIENT REVIEW	JUNE 09, 2026	
2	ISSUED FOR CLIENT REVIEW	DEC 18, 2025	
1	ISSUED FOR CLIENT REVIEW	DEC 16, 2025	
No.	Description	Date	Rev.

CLIENT:

<b>640 LIVERPOOL ROAD</b>		ELEVATION:	Drawing No.
<b>MARCH SHADOW STUDY</b>		DATE ISSUED:	SH-101
<b>TOWNHOUSES</b>			DEC 16, 2025

PROJECT #:	MARKETING NAME:	 S&C Architects Inc. 60 RANDALL DRIVE, SUITE 10, AJAX, ONTARIO L1S 6L3
2022-10	-	
SCALE:	MUNICIPALITY:	
N.T.S		

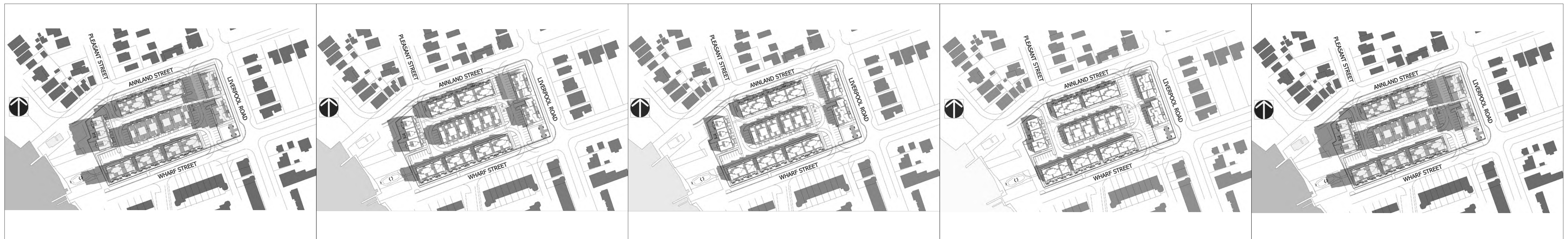

21 JUNE 7:00AM

21 JUNE 8:00AM

21 JUNE 9:00AM

21 JUNE 10:00AM

21 JUNE 11:00AM

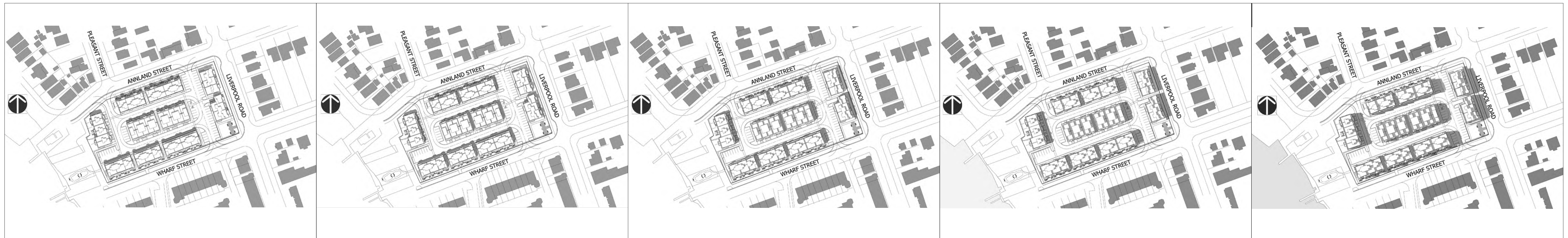

21 JUNE 12:00PM

21 JUNE 1:00PM

21 JUNE 2:00PM

21 JUNE 3:00PM

21 JUNE 4:00PM

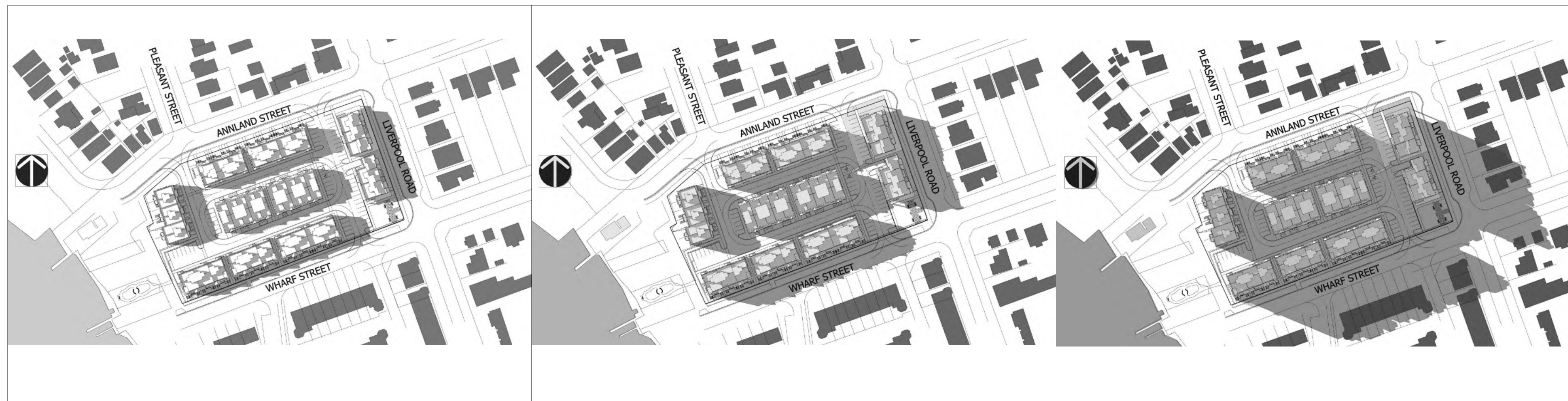

21 JUNE 5:00PM

21 JUNE 6:00PM

21 JUNE 7:00PM

**PROPOSED BUILDING. 3-STOREY TOWNHOMES**

THIS SHADOW ANALYSIS HAS BEEN PREPARED IN ACCORDANCE WITH THE CITY OF PICKERING TERMS OF REFERENCE FOR SHADOW/SHADING STUDY. THE ANALYSIS DEMONSTRATES THE SHADOW IMPACT BY THE PROPOSED DEVELOPMENT THROUGHOUT THE YEAR ON THE LANDS ADJACENT TO THE SUBJECT PROPERTY BY THE PROPOSED 3 STOREY TOWNHOMES BUILDING.

THE SHADOW CAST BY THE PROPOSED BUILDING HAS BEEN DEVELOPED USING A 3D SKETCHUP MODEL WHICH HAS BEEN GEOLOCATED. ONTARIO UTC-5

2	ISSUED FOR CLIENT REVIEW	JUNE 09, 2025	
1	ISSUED FOR CLIENT REVIEW	DEC 16, 2025	
No.	Description	Date	Rev.

<p align="center"><b>640 LIVERPOOL ROAD</b></p>		ELEVATION:	Drawing No.
<p align="center"><b>JUNE SHADOW STUDY</b></p>		DATE ISSUED:	DEC 16, 2025
<p align="center"><b>TOWNHOMES</b></p>			

PROJECT #:	MARKETING NAME:	<p align="center">S&amp;C Architects Inc. 60 RANDALL DRIVE, SUITE 10, AJAX, ONTARIO L1S 6L3</p>
2022-10	-	
SCALE:	MUNICIPALITY:	
N.T.S		

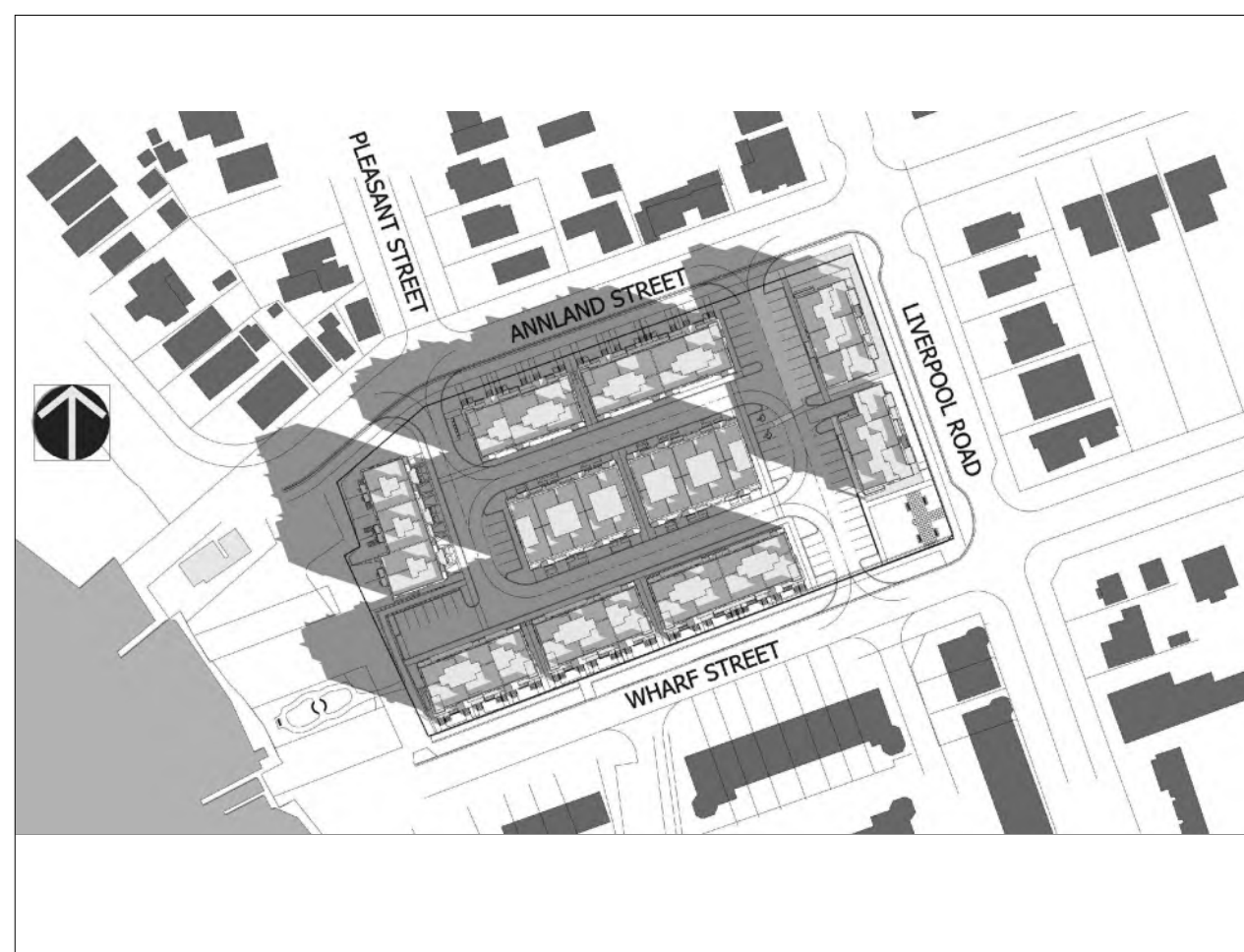

21 SEPTEMBER 8:00AM



21 SEPTEMBER 9:00AM

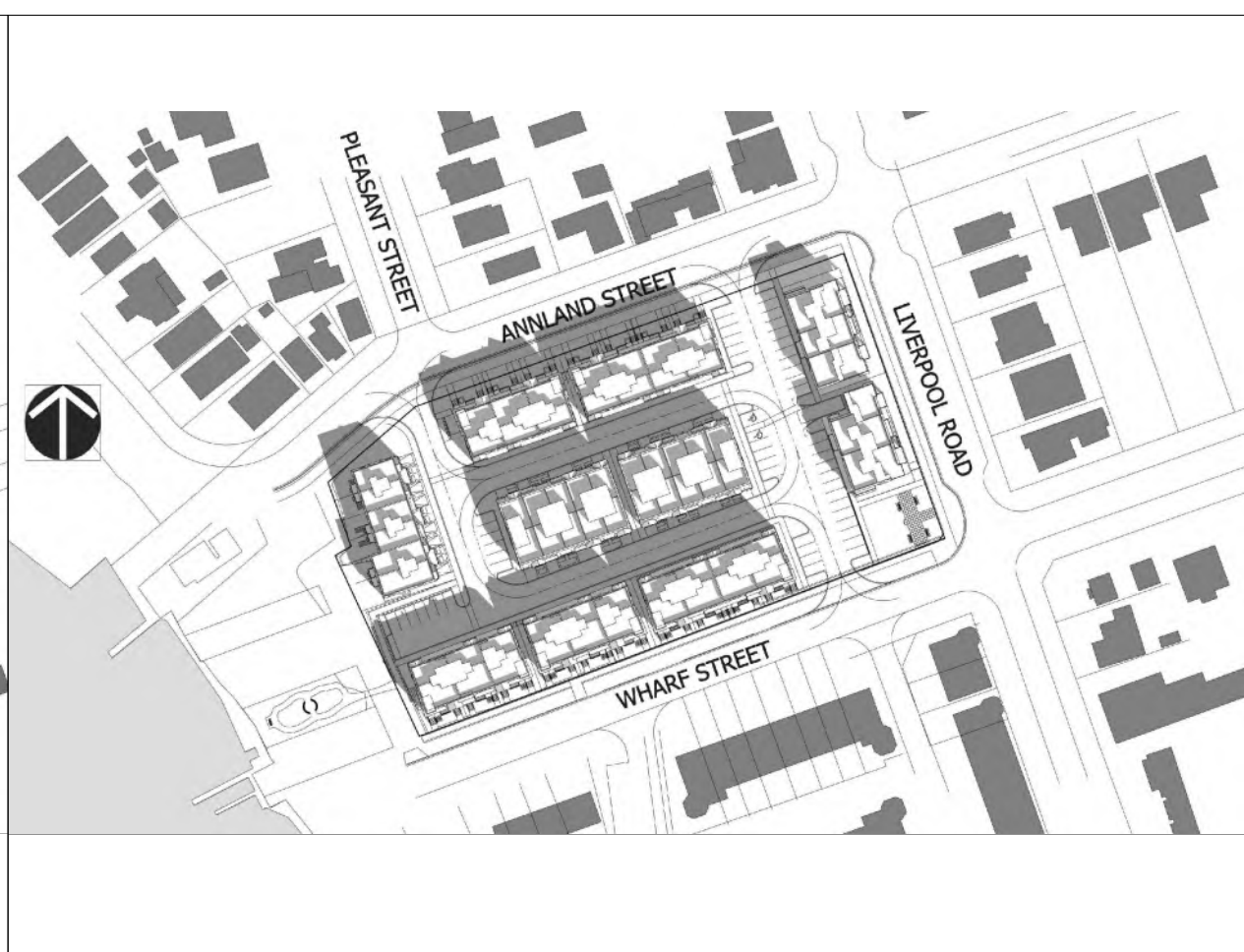

21 SEPTEMBER 10:00AM



21 SEPTEMBER 11:00AM



21 SEPTEMBER 12:00PM



21 SEPTEMBER 1:00PM

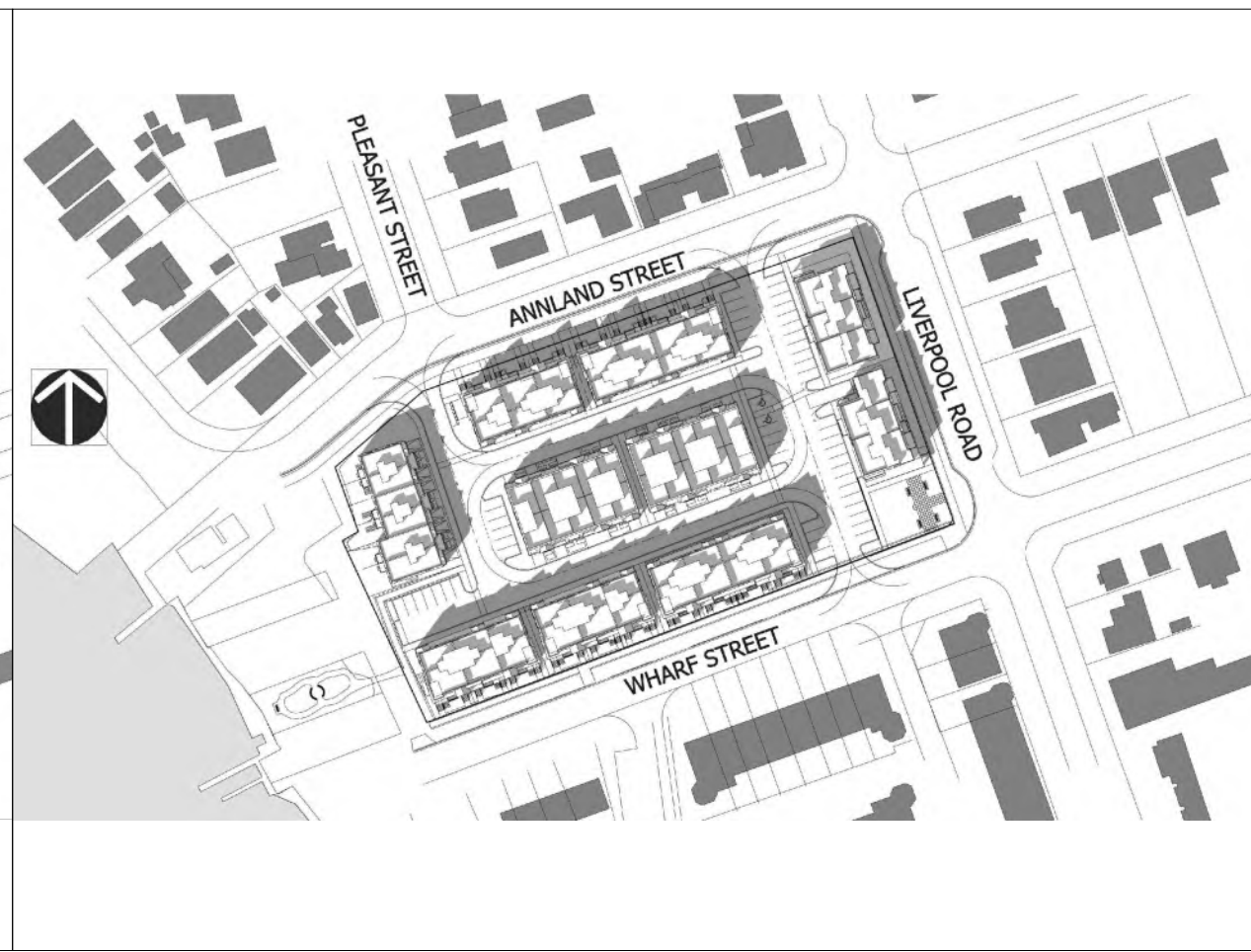

21 SEPTEMBER 2:00PM



21 SEPTEMBER 3:00PM

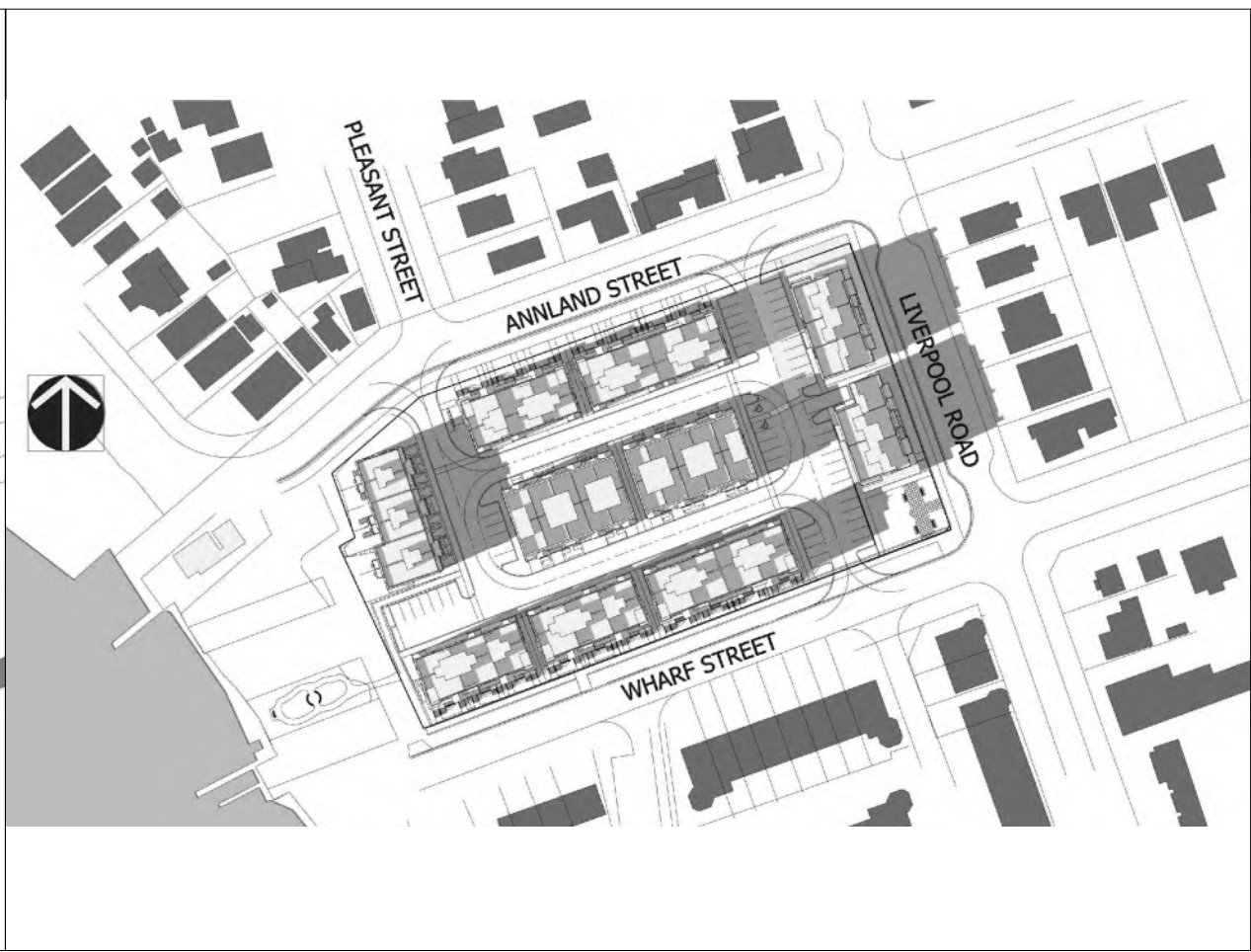

21 SEPTEMBER 4:00PM

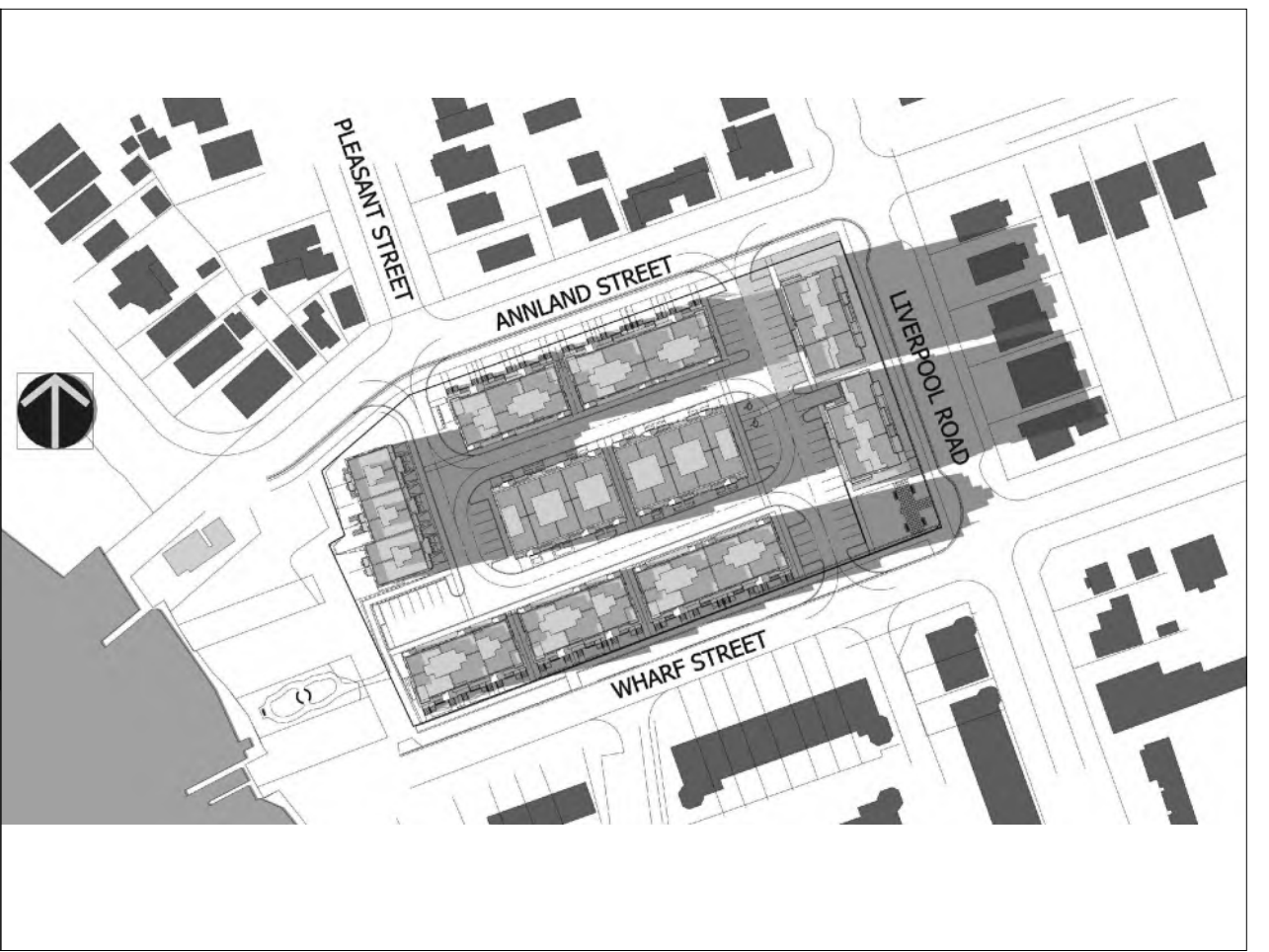

21 SEPTEMBER 5:00PM

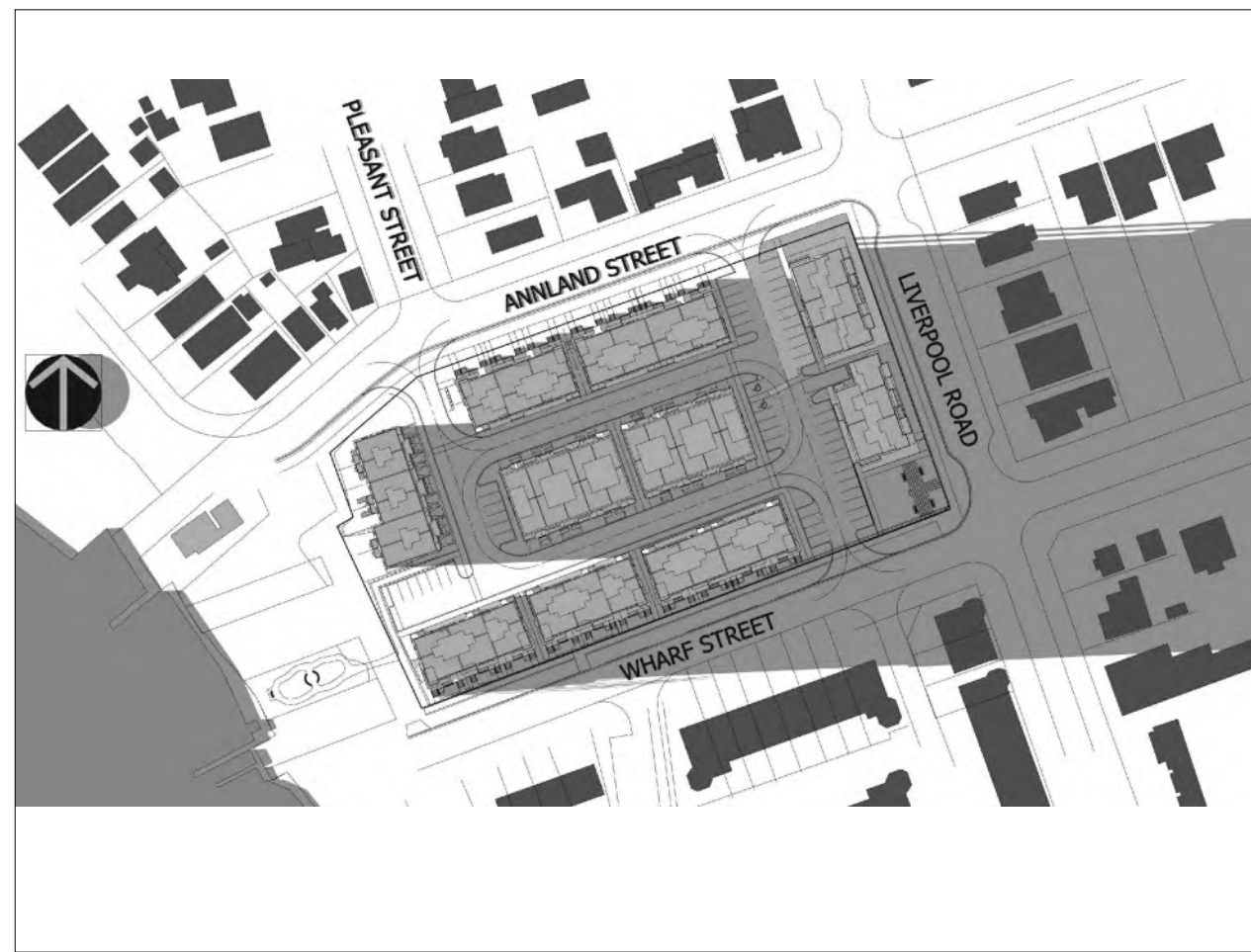

21 SEPTEMBER 6:00PM

**PROPOSED BUILDING. 3-STOREY TOWNHOMES**

THIS SHADOW ANALYSIS HAS BEEN PREPARED IN ACCORDANCE WITH THE CITY OF PICKERING TERMS OF REFERENCE FOR SHADOW/SHADING STUDY. THE ANALYSIS DEMONSTRATES THE SHADOW IMPACT BY THE PROPOSED DEVELOPMENT THROUGHOUT THE YEAR ON THE LANDS ADJACENT TO THE SUBJECT PROPERTY BY THE PROPOSED 3 STOREY TOWNHOMES BUILDING.

THE SHADOW CAST BY THE PROPOSED BUILDING HAS BEEN DEVELOPED USING A 3D SKETCHUP MODEL WHICH HAS BEEN GEOLOCATED. ONTARIO UTC-5

2	ISSUED FOR CLIENT REVIEW	JUNE 09, 2026	
1	ISSUED FOR CLIENT REVIEW	DEC 16, 2025	
No.	Description	Date	Rev.

CLIENT:

<b>640 LIVERPOOL ROAD</b>		ELEVATION:	Drawing No.
<b>SEPTEMBER SHADOW STUDY</b>		DATE ISSUED:	SH-103
<b>TOWNHOUSES</b>			DEC 16, 2025

PROJECT #:	MARKETING NAME:	 S&C Architects Inc. 60 RANDALL DRIVE, SUITE 10, AJAX, ONTARIO L1S 6L3
2022-10	-	
SCALE:	MUNICIPALITY:	
N.T.S		

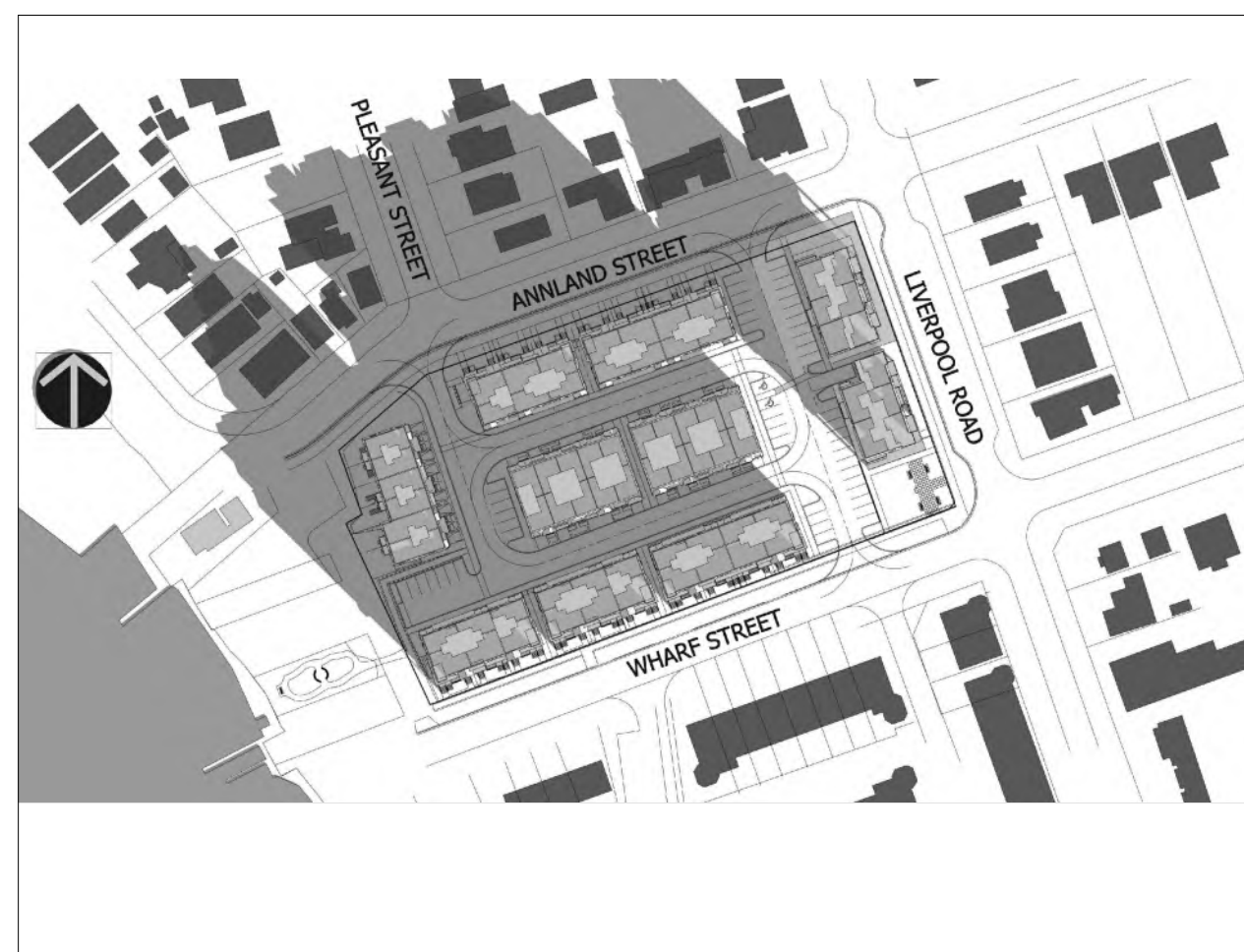

21 DECEMBER 9:00AM



21 DECEMBER 10:00AM



21 DECEMBER 11:00AM

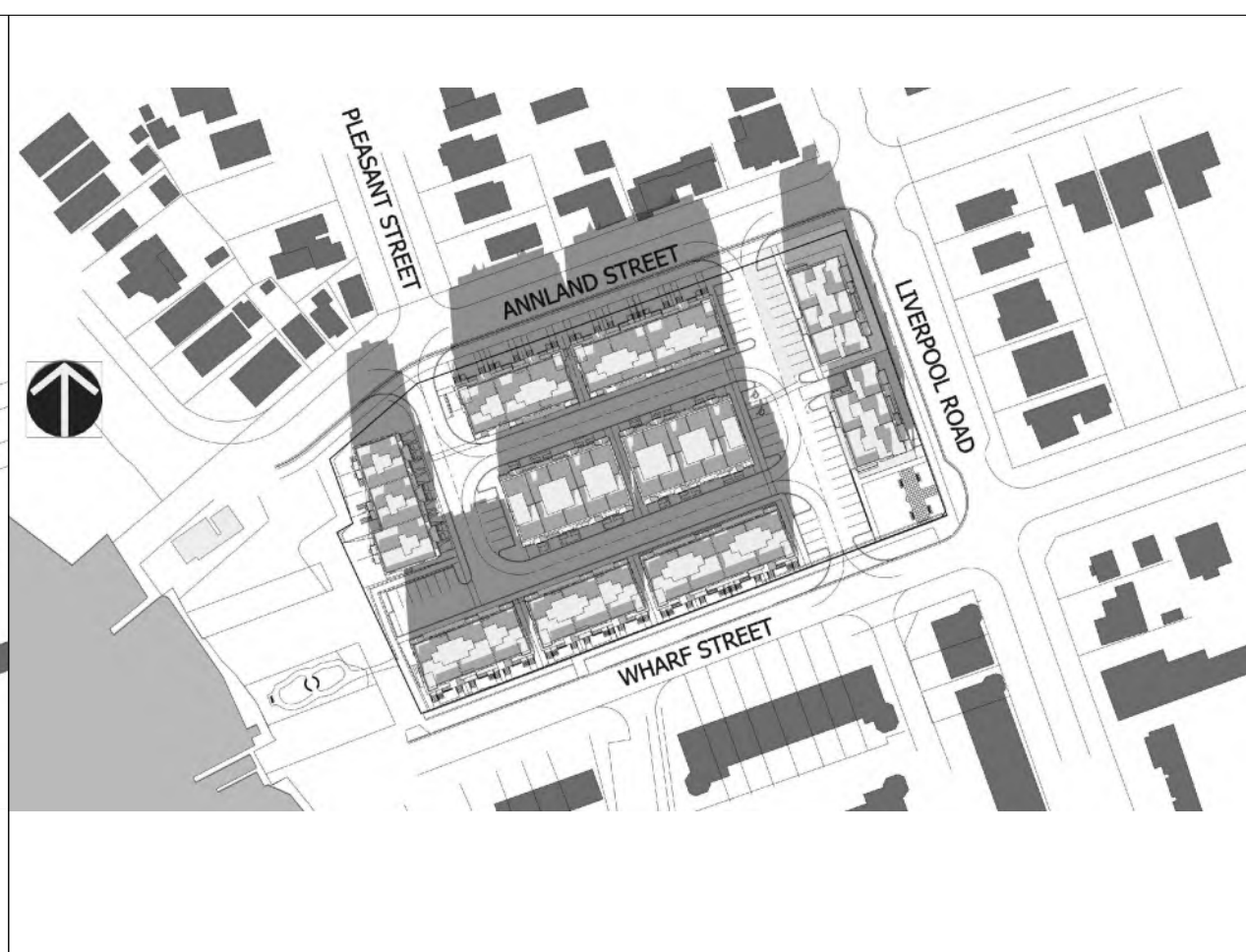

21 DECEMBER 12:00PM

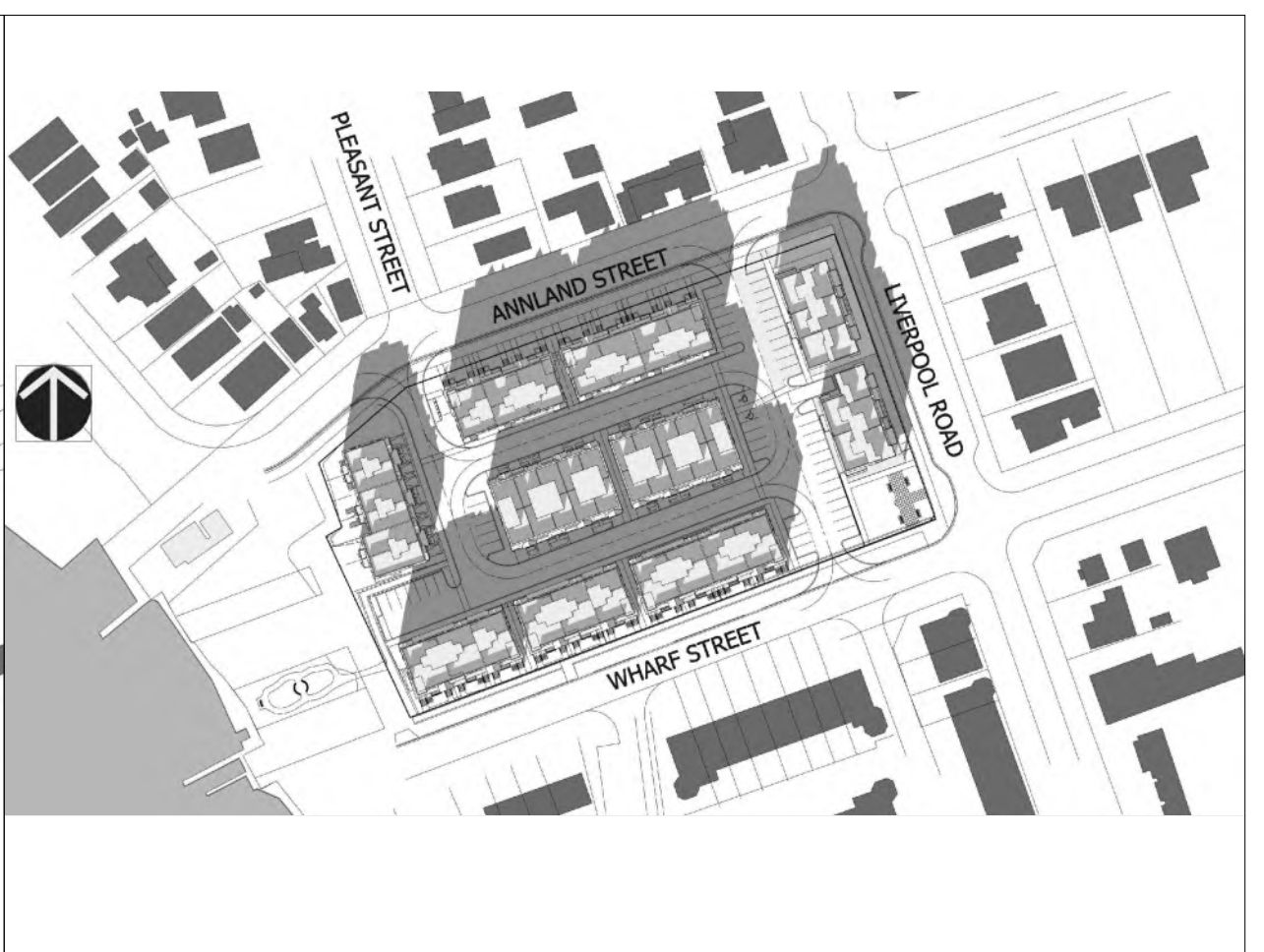

21 DECEMBER 1:00PM

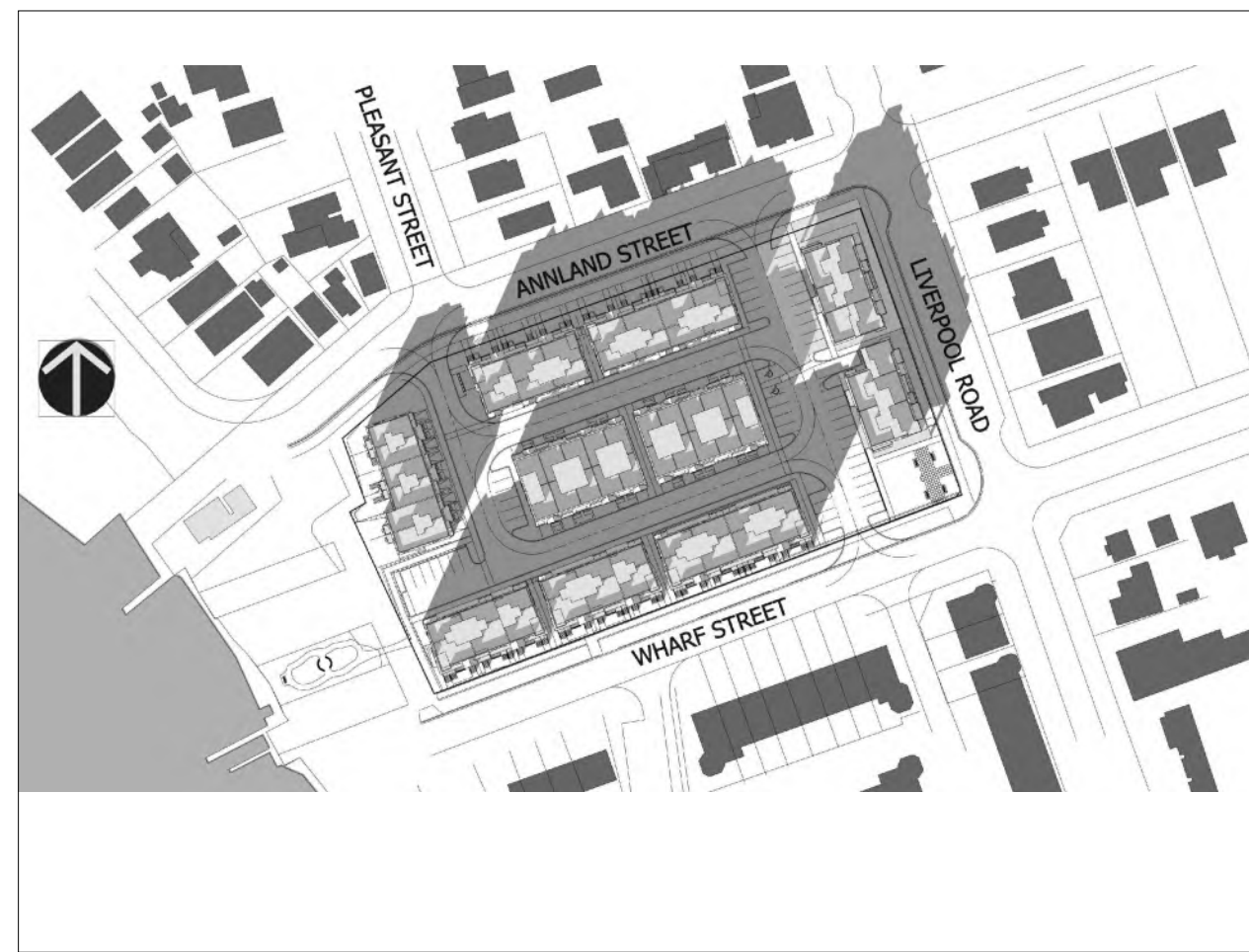

21 DECEMBER 2:00PM

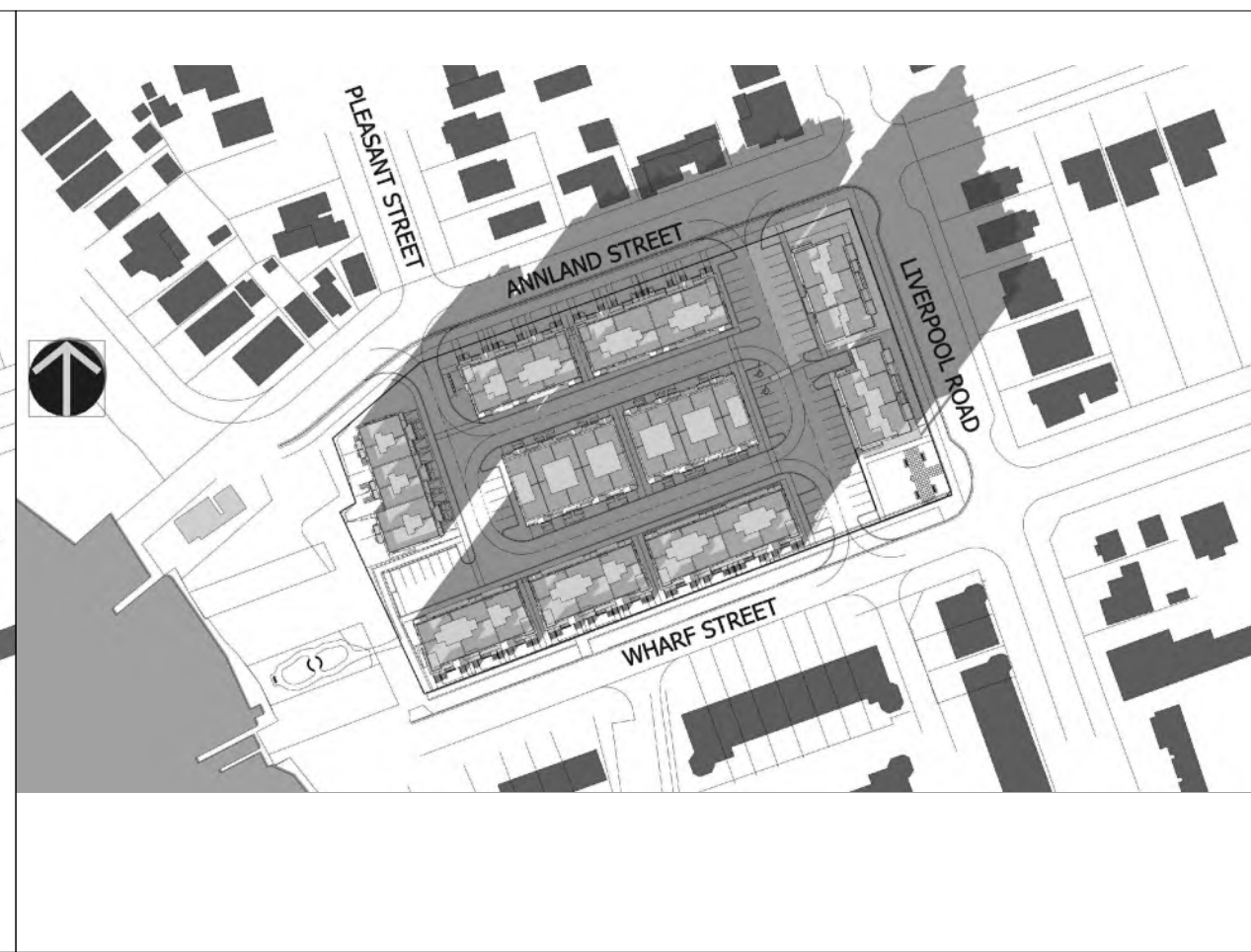

21 DECEMBER 3:00PM

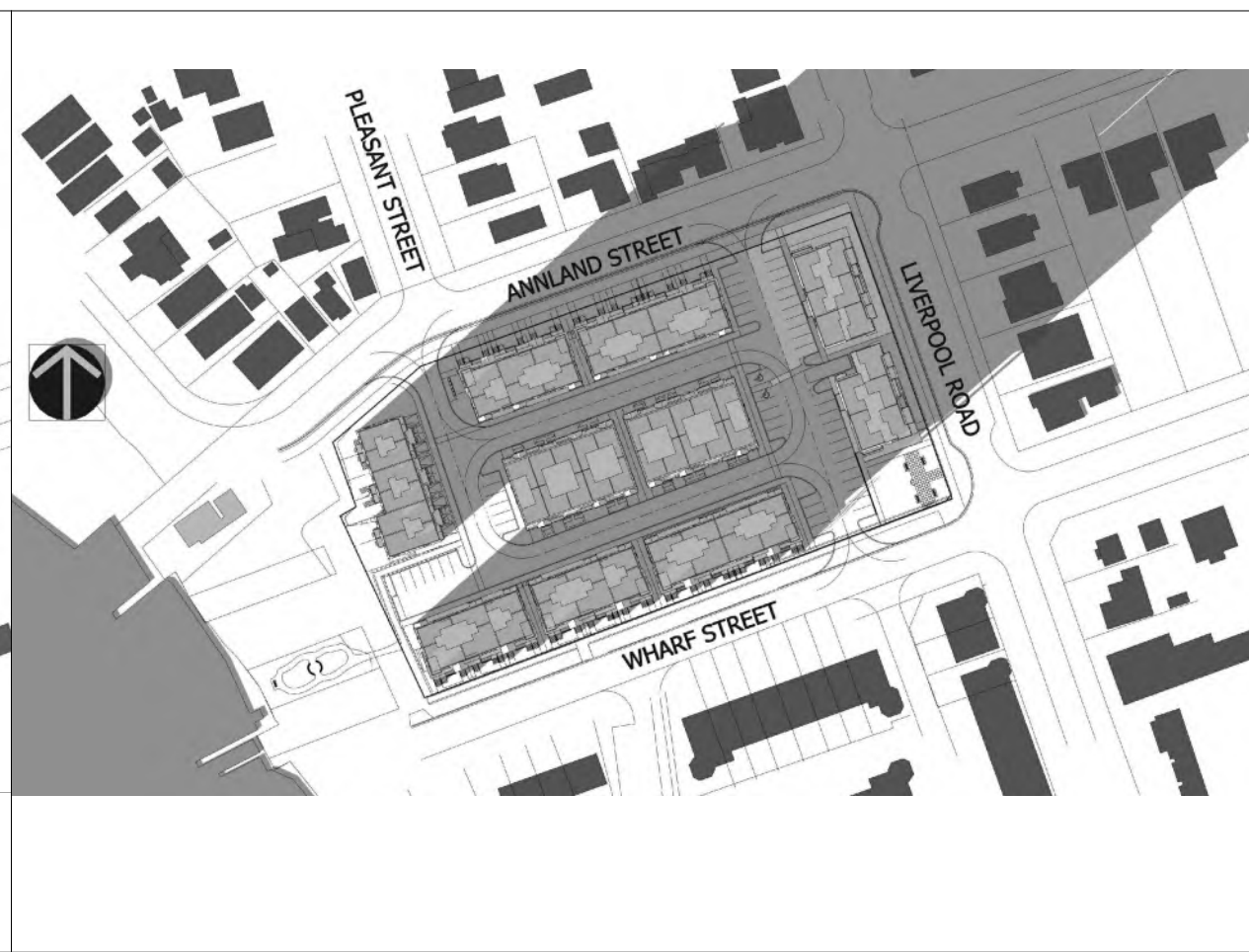

21 DECEMBER 4:00PM

**PROPOSED BUILDING. 3-STOREY TOWNHOMES**

THIS SHADOW ANALYSIS HAS BEEN PREPARED IN ACCORDANCE WITH THE CITY OF PICKERING TERMS OF REFERENCE FOR SHADOW/SHADING STUDY. THE ANALYSIS DEMONSTRATES THE SHADOW IMPACT BY THE PROPOSED DEVELOPMENT THROUGHOUT THE YEAR ON THE LANDS ADJACENT TO THE SUBJECT PROPERTY BY THE PROPOSED 3 STOREY TOWNHOMES BUILDING.

THE SHADOW CAST BY THE PROPOSED BUILDING HAS BEEN DEVELOPED USING A 3D SKETCHUP MODEL WHICH HAS BEEN GEOLOCATED. ONTARIO UTC-5

2	ISSUED FOR CLIENT REVIEW	JUNE 09, 2026	
1	ISSUED FOR CLIENT REVIEW	DEC 16, 2025	
No.	Description	Date	Rev.

CLIENT:

<b>640 LIVERPOOL ROAD</b>		ELEVATION:	Drawing No.
<b>DECEMBER SHADOW STUDY</b>		DATE ISSUED:	<b>SH-104</b>
<b>TOWNHOUSES</b>			<b>DEC 16, 2025</b>

PROJECT #:	MARKETING NAME:	 <b>S&amp;C</b> Architects Inc. 60 RANDALL DRIVE, SUITE 10, AJAX, ONTARIO L1S 6L3
2022-10	-	
SCALE:	MUNICIPALITY:	
N.T.S		