

THE INFORMATION IN THIS SITE PLAN IS FROM
PLAN OF SURVEY OF
PART OF LOTS 9, 10 & 13
AND
LOTS 11 & 12
BLOCK D
REGISTERED PLAN 65
TOWN OF PICKERING
(REGIONAL MUNICIPALITY OF DURHAM)
SCALE 1:200
RICHMOND SURVEYING INC.
© COPYRIGHT 2023

Conditions of Use
Verify elevations and/or dimensions on drawing prior to use.
Report any discrepancies to Dillon Consulting Limited.
Do not scale dimensions from drawing.
Do not modify drawing, re-use it, or use it for purposes other than those intended at the time of its preparation without prior written permission from Dillon Consulting Limited.

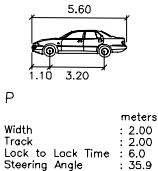

DILLON
CONSULTING

1	Vehicle Sweep Path Analysis	2024-05-21	MS
No.	ISSUED FOR	DATE	BY

DESIGN	REVIEWED BY
MS	ES
DRAWN	CHECKED BY
MS	ES
DATE	2025-05-21
SCALE	1:500

PROPOSED DEVELOPMENT AT 666 LIVERPOOL ROAD
TOWN OF PICKERING
SITE CIRCULATION
(PASSENGER VEHICLE)

PROJECT NO.
24-9382
SHEET NO.
T-7

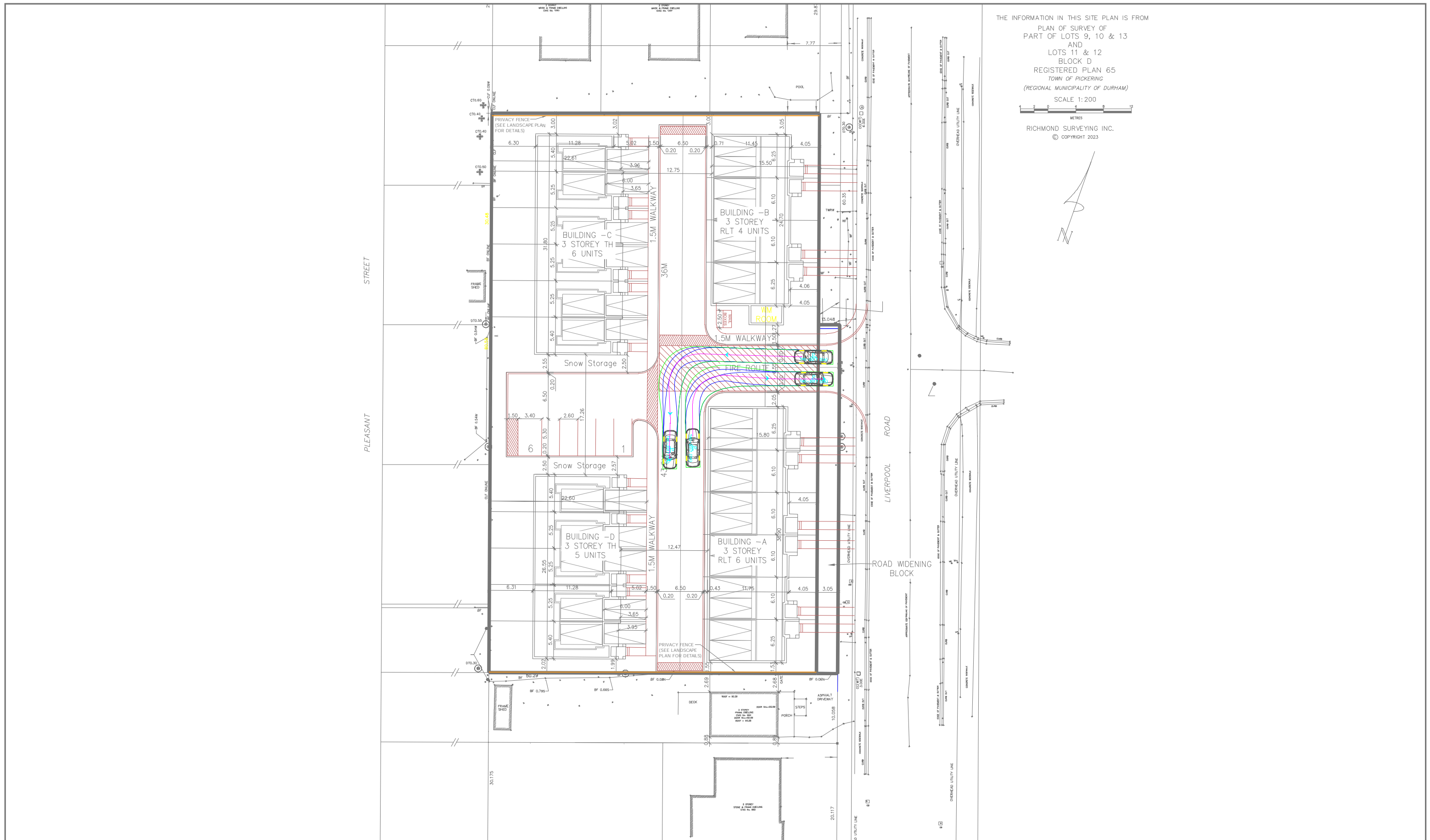
[illegible]