

Seaton Recreation Complex & Library

Schematic Design Option 4

2025/02/03

Artist concept rendering

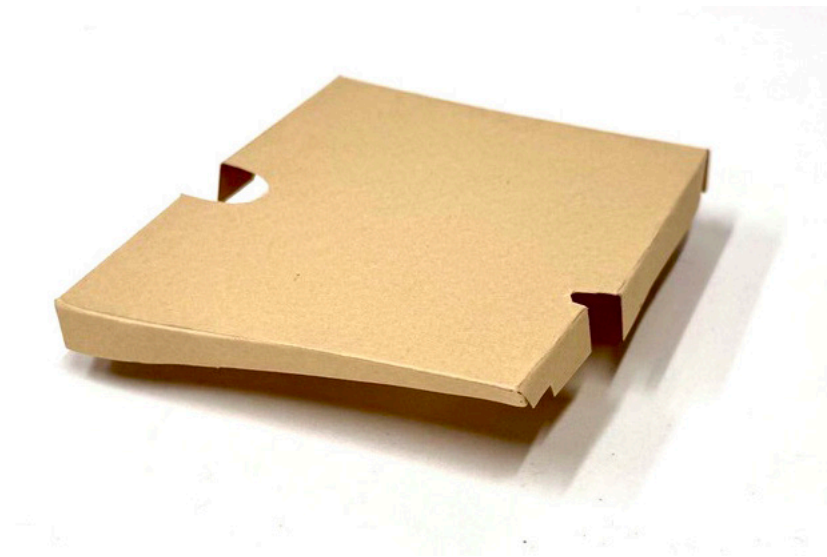

Seaton Recreation Complex & Library

An expressive roof caps recreational program nestled in a topographical landscape.

Context Plan

The City of Pickering has an extensive natural heritage system which is comprised of a network of woodlands and watercourses within the Duffins Creek Watershed. To ensure the health and ongoing preservation of this system, it is important for residents to experience the natural beauty and appreciate the richness it brings to daily life in the community. The Seaton Recreation and Library site is conceived as a gateway to nature, extending topography and native flora onto the site and inserting nodes of activity and gathering within.



Ganatsekiagon Creek



Concept

Introduce Topography to create a journey of discovery

Generate more naturalized landforms and
reference the pregraded landscape.



Existing site condition



Concept

Carve plateaus for program

Remaining berm landforms provide visual and acoustic privacy between programs and offer views to nature.



Concept

The Big Roof: Unifying Shelter

A pavilion canopy floats over the indoor program creating an articulated connection between interior and exterior.

The roof is sculpted to accentuate entries and gathering spaces.

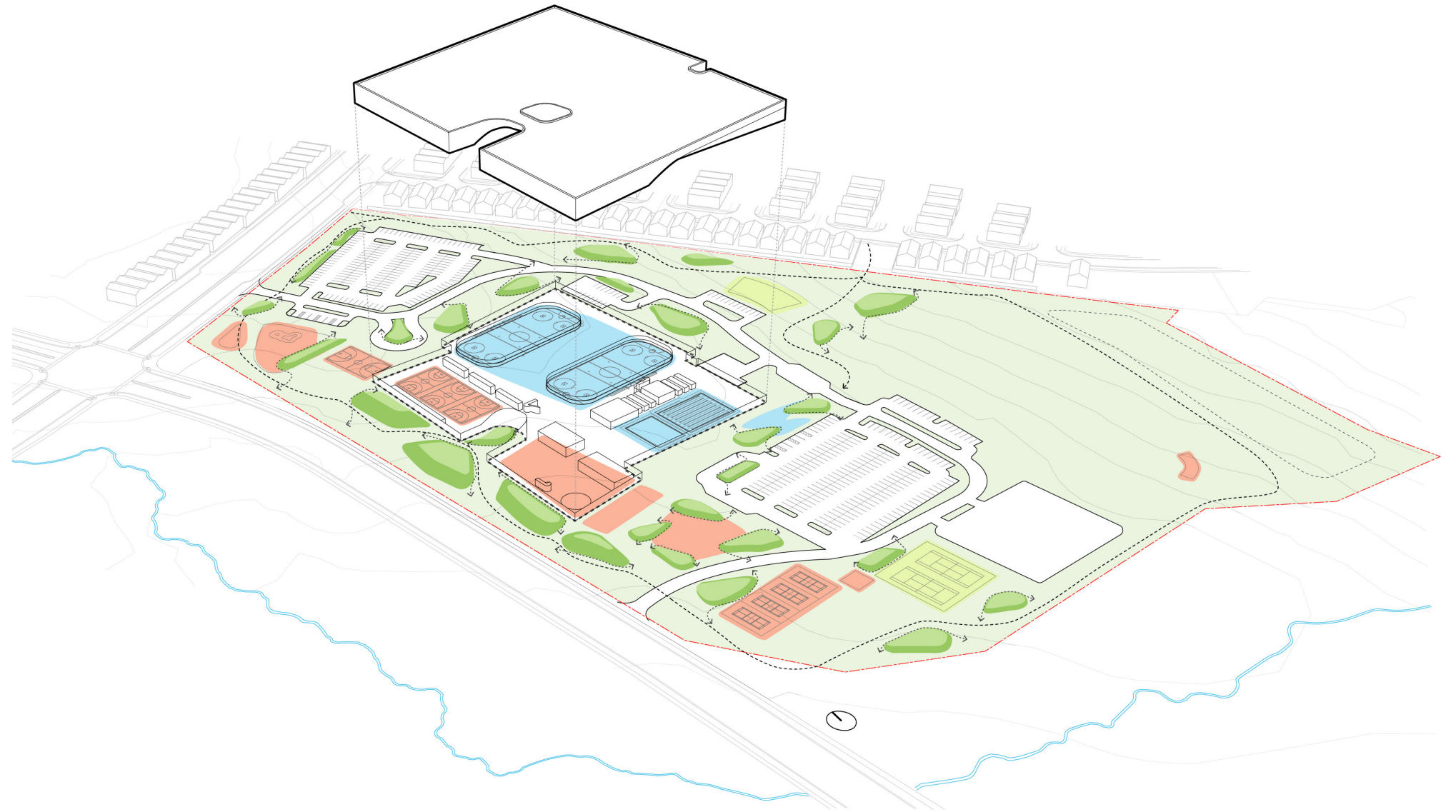

Aerial View from North-West

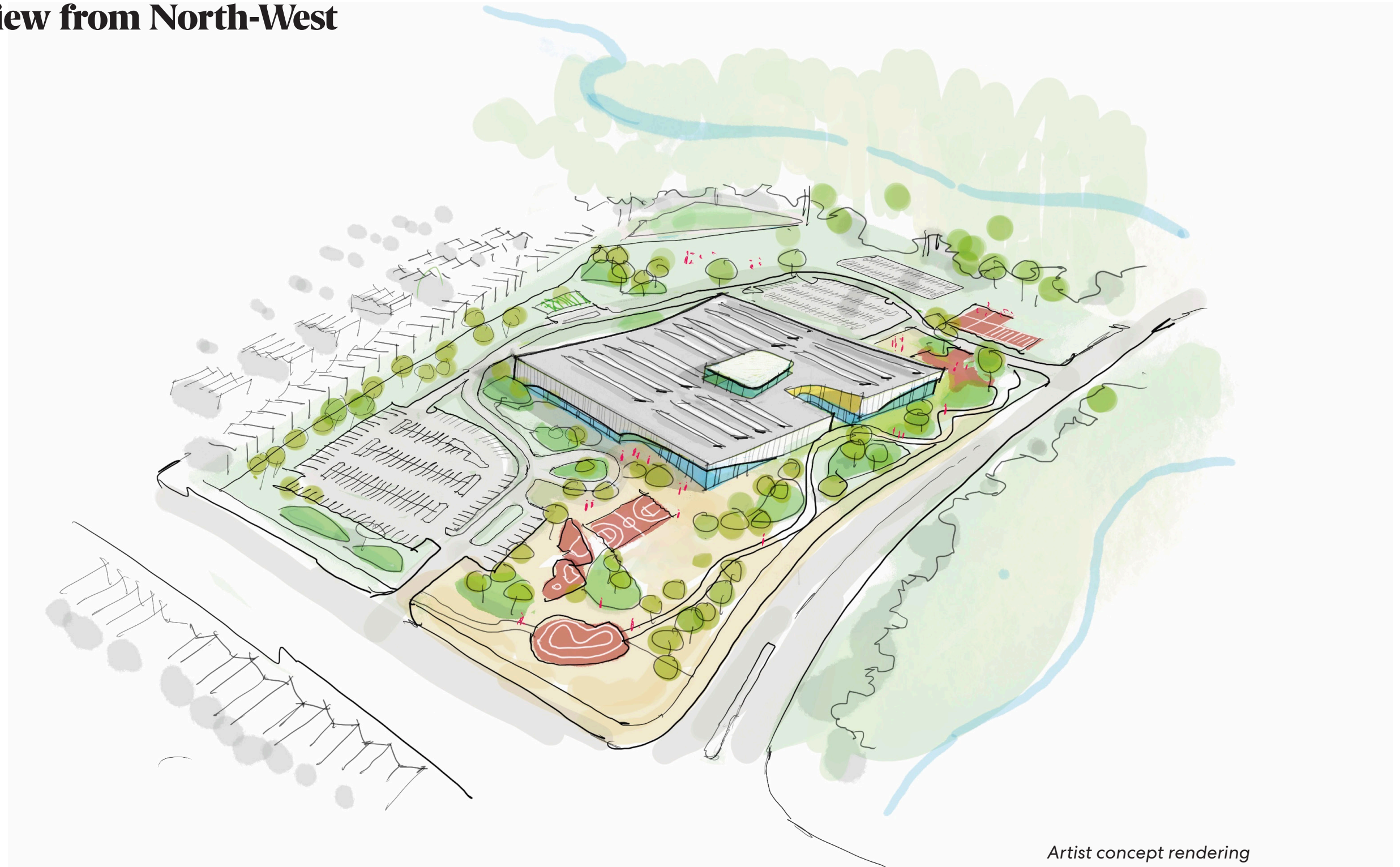

Artist concept rendering

Site Plan - Base Program

The building is situated almost centrally on the site in the North/South axis to provide two clear entry points and parking areas. The building main axis is aligned with Burkholder Drive to provide a continuous streetwall and maximize space on the east side of the site for future programming. A 30m setback from Burkholder Drive creates space for a continuous 1.2km trail that wraps the site and connects exterior amenities.

Teen-dominated programs such as the skateboard park and basketball courts are co-located in the northwest corner of the site. Children-dominated programs including the playground and splashpad are co-located on the south entry plaza. A reading garden flanks the library. Pickleball and tennis courts sit just south of the main entry plaza, with nearby access to parking and visual and acoustic privacy from adjacent programs and residential areas.

A ring road wanders through the site connecting the two lots and providing an access spine to the east side back of house areas of the building.



Site Plan - Optional Program

The refrigerated outdoor ice trail sits just north of the arenas allowing for easy ice resurfacer access and animation of the north entry plaza.

One additional basketball court and four additional pickleball courts are co-located near their corresponding base program courts.

An expanded 12,000 sq ft skateboard park footprint is placed over the base program 1,200 sq ft skate park.





One illuminated senior soccer field fills in the east edge of the site with program. This field can also be divided in half and function as two junior soccer fields.

A pavilion/covered stage sits between the fields in the corner of the site, utilizing natural grade change to provide tiered views to the stage. The grassy soccer field serve as overflow spectator space.

Outdoor washrooms become part of the shade structure between the pickleball and tennis courts.

- 1. Additional Basketball Court
- 2. Refrigerated Outdoor Ice Trail
- 3. Four Additional Pickleball Courts
- 4. Outdoor Washroom Facility
- 5. Senior Soccer Field
- 6. Pavilion/Covered Stage

Legend:

-  Site Entry/Exit
-  Building Entry/Exit
-  Pedestrian Pathways
-  Neighborhood



South Entry Plaza

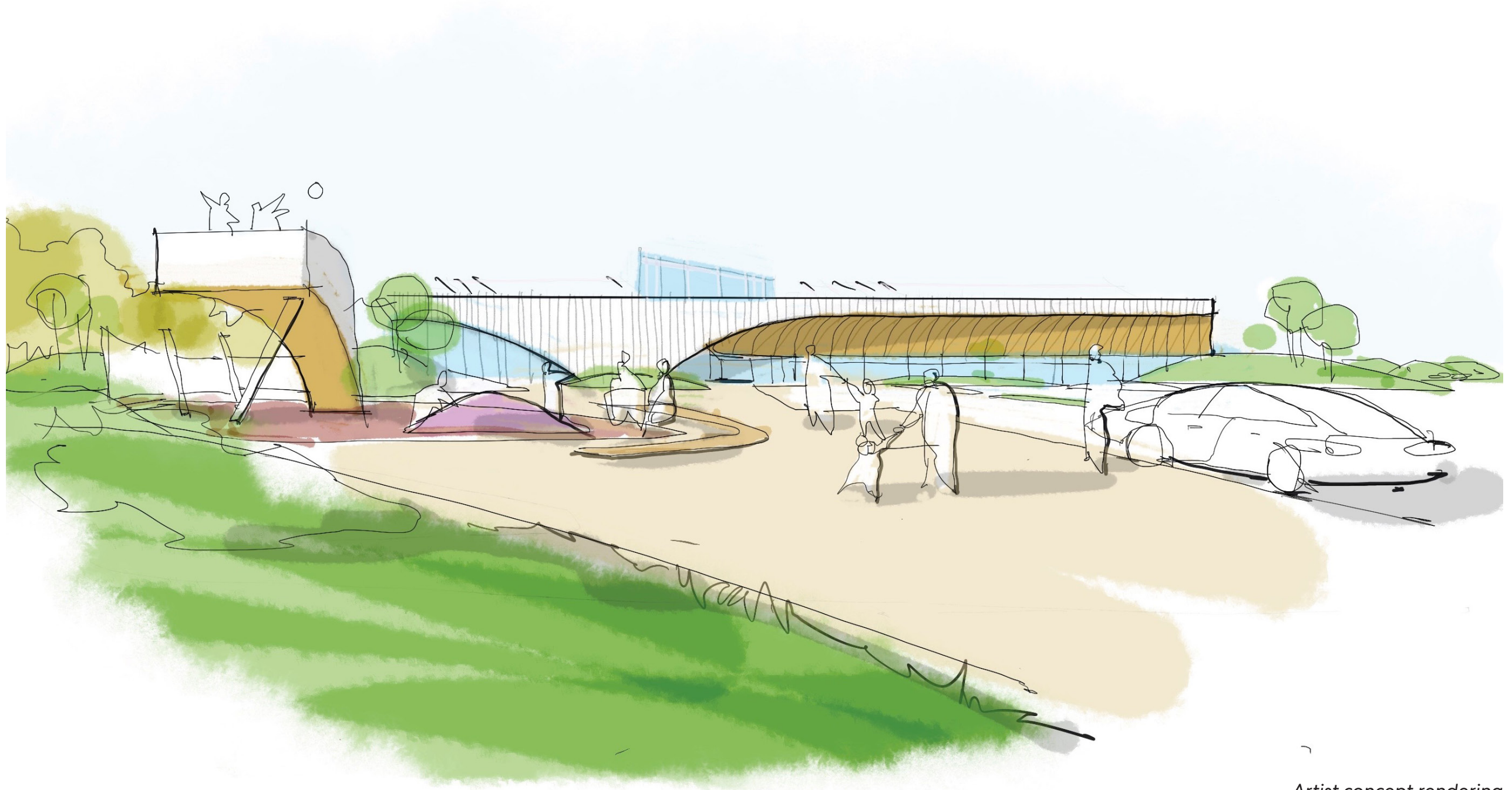

Artist concept rendering

North Entry Plaza

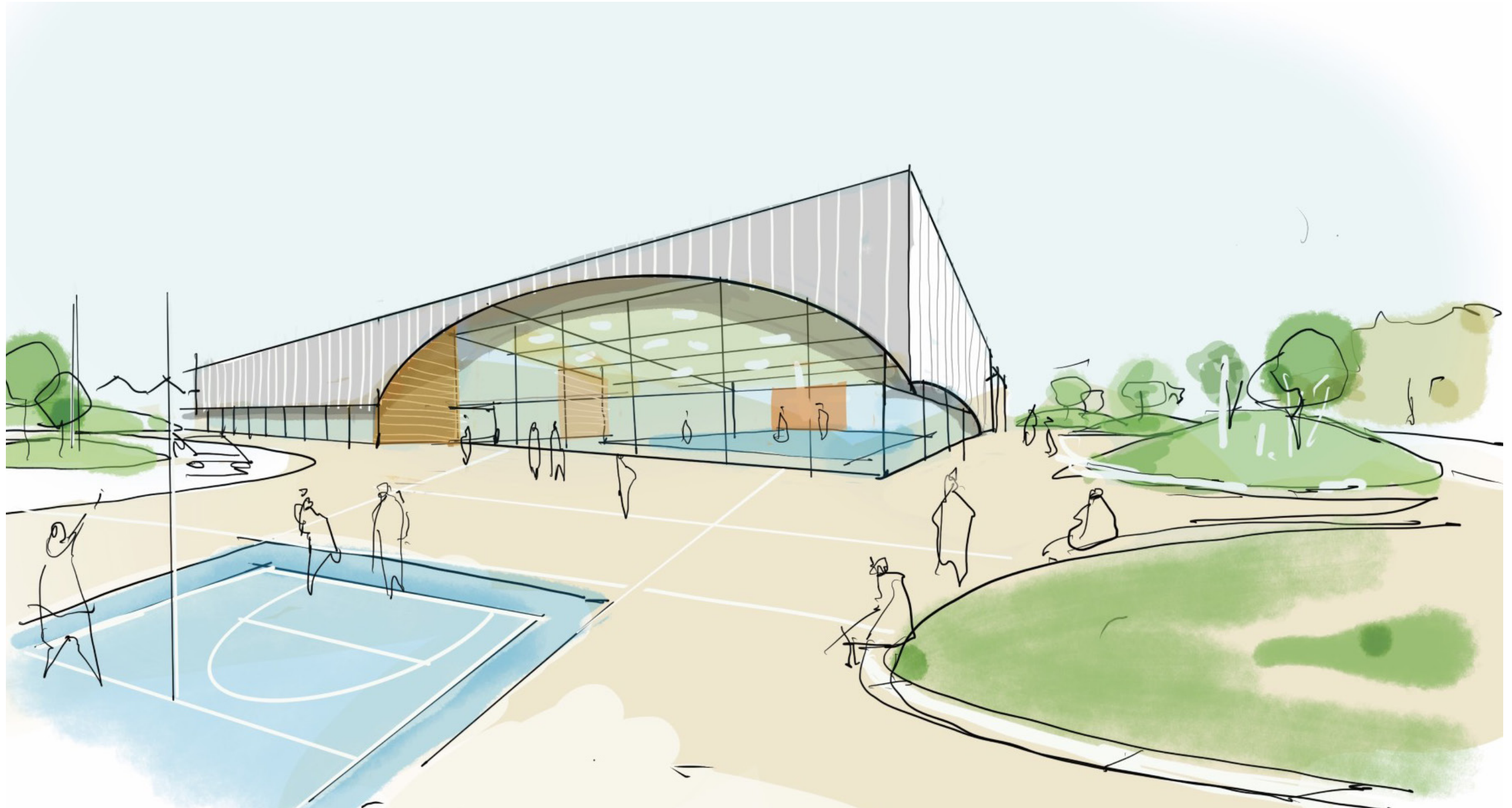

Artist concept rendering

Level 1

The four key programs of the building pinwheel around a central lobby. The arenas are located in the northeast quadrant to minimize solar heat gain from southerly light. The aquatics centre sits just south of the arenas to animate the south main entrance and to cluster back of house programs along the east facade. The library sits in the southwest quadrant, animating both the south main entrance and Burkholder Drive. The triple gym completes the square in the northwest quadrant, allowing for views from the street and north entry as well as access to all three gyms from the lobby.

The lobby swells and shrinks along its axis to respond to circulation demands and create a central gathering space.

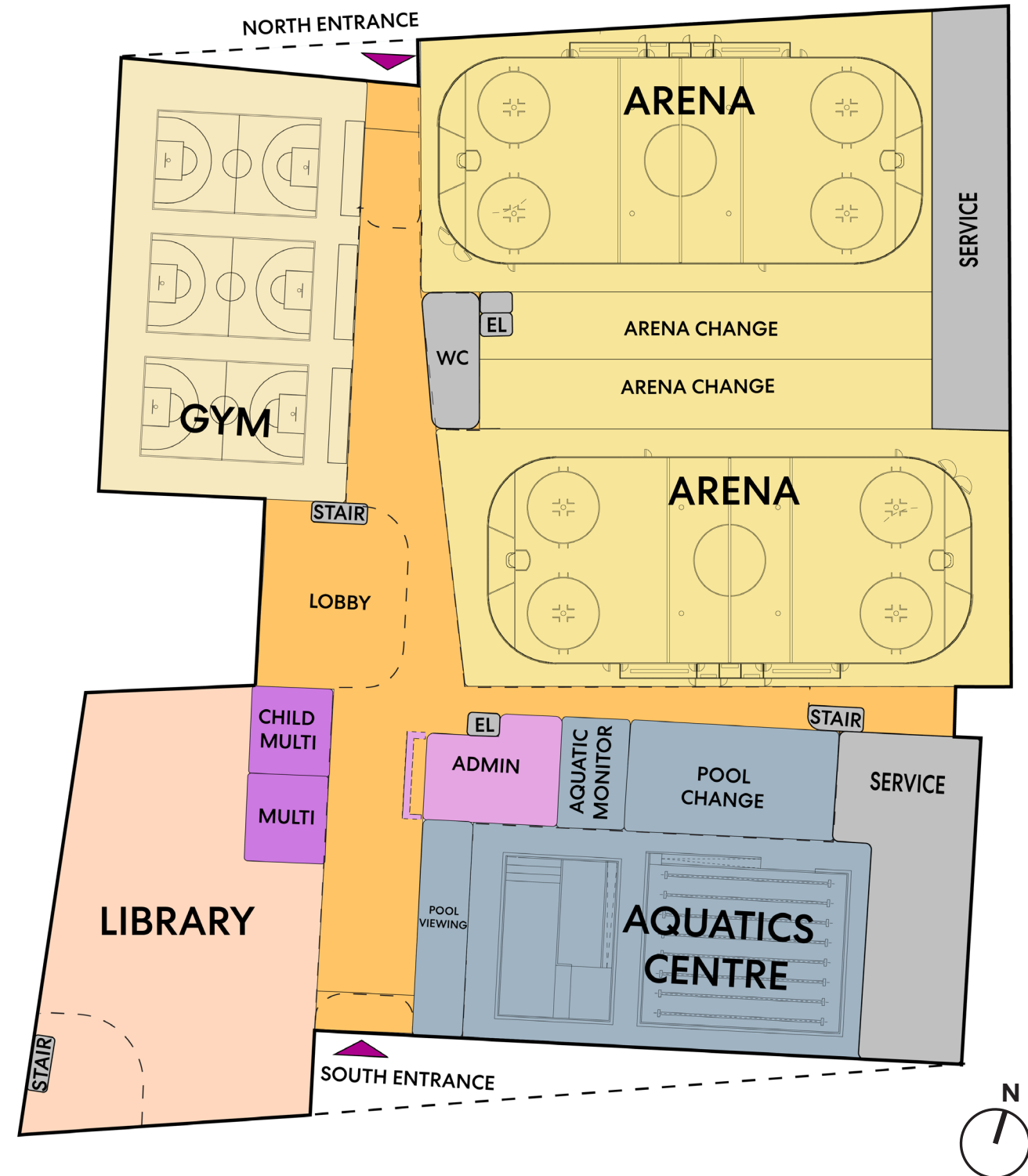

Atrium

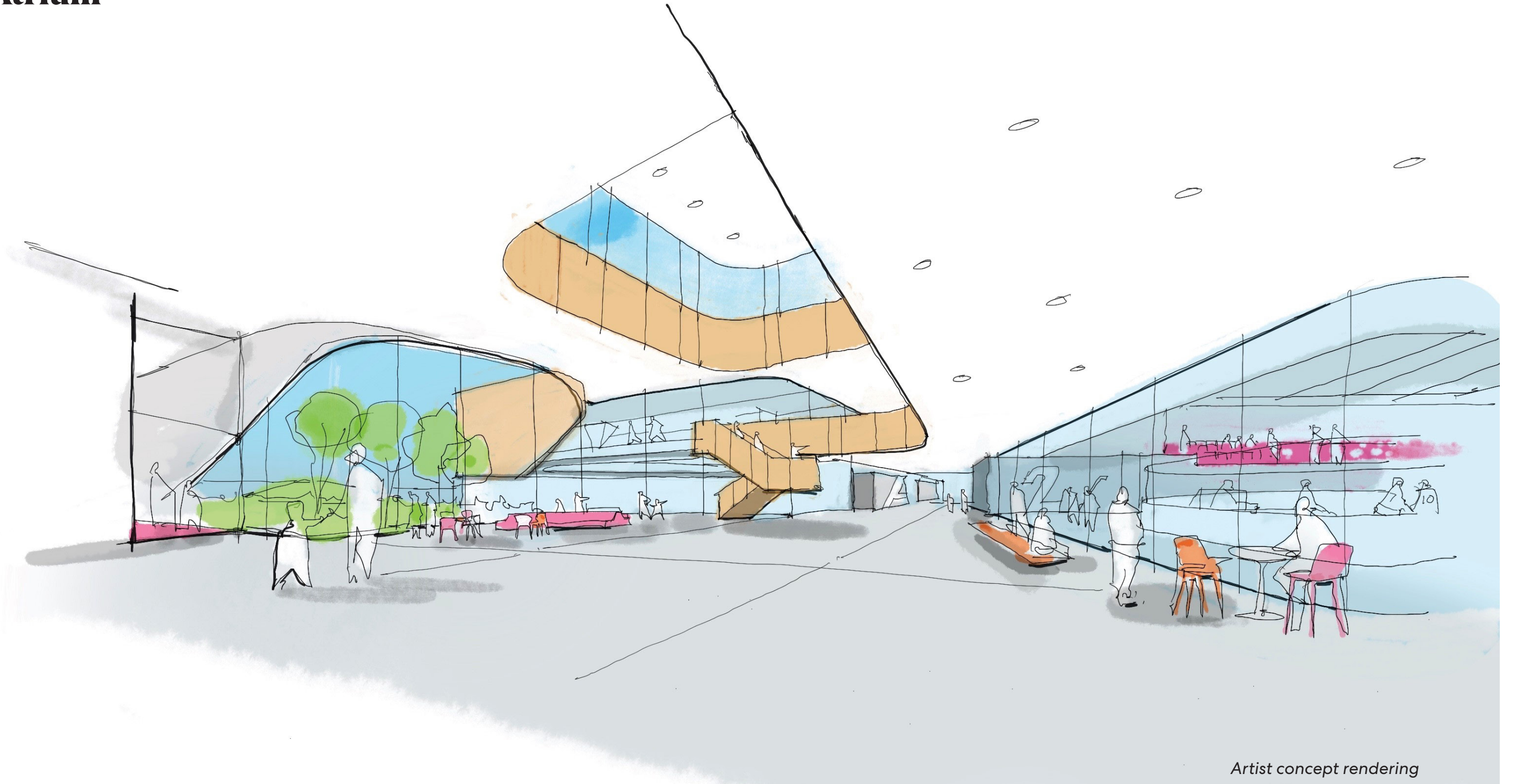

Artist concept rendering

Level 2

The level two program responds to the locations of programs below. A viewing area for 400 spectators bridges between the two arenas.

The fitness area and health club stack above the pool change rooms below providing unique views to the arena, pool and outdoor field beyond.

The library and admin area stack over the library box below while a 3 lane track encircles the gym.

The level two programs are connected by a sculpted lobby floor plate that creates delightful double height spaces and views to the activity below.

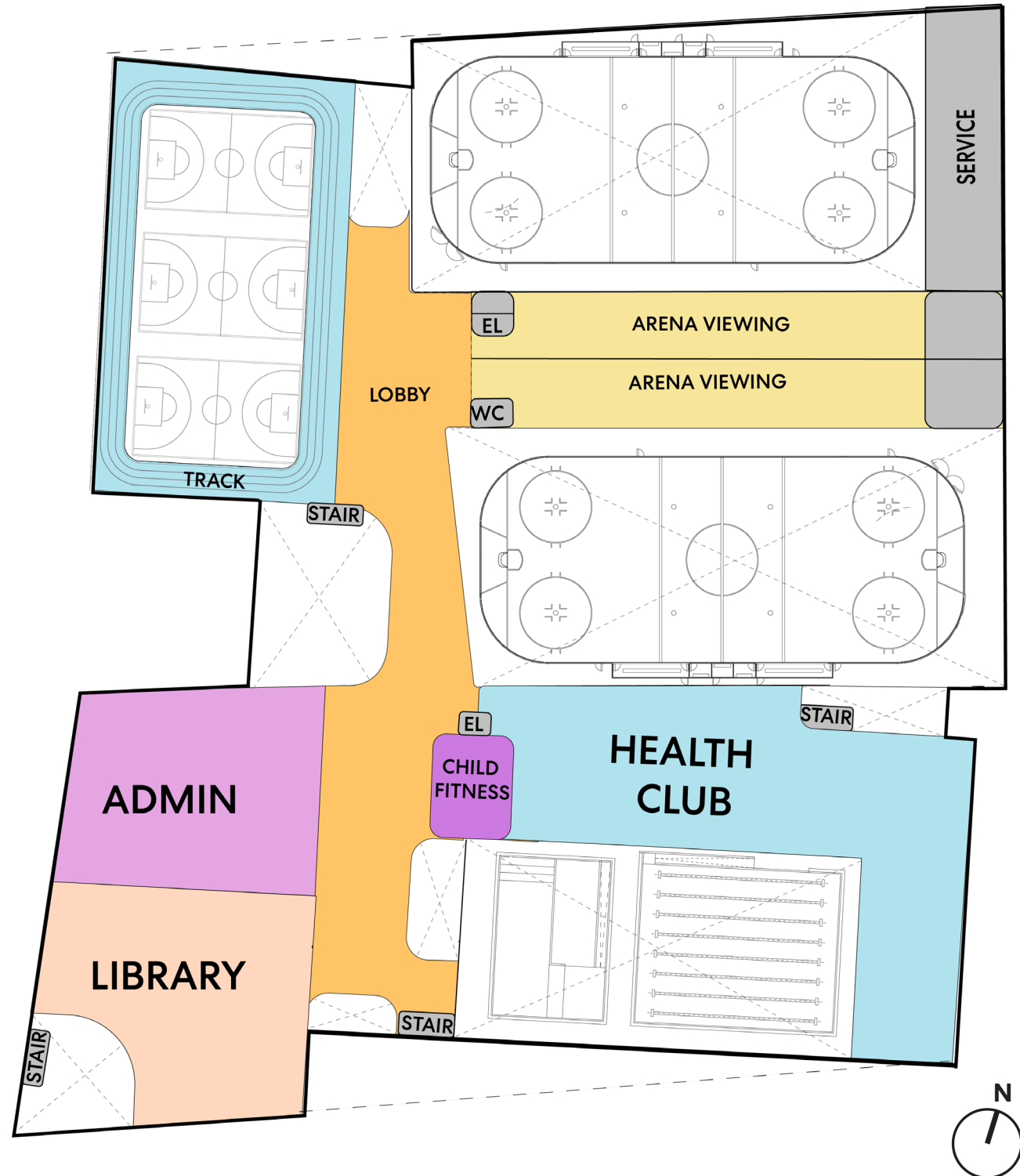

Level 0

The basement floor plate is compact and simple. A pool mechanical room sits below the pool back of house area and alongside the deep end of the lap pool.

